

A red Bourgault X30 Apollo irrigation system is shown in a field of tall, golden-brown grass. The system features multiple large black wheels, yellow hydraulic arms, and numerous white corrugated hoses that curve upwards from the main body. The background shows a clear blue sky and a distant treeline.

**BOURGAULT**

**X30** Apollo | System

INGENUITY.

SIMPLICITY.

DURABILITY.

 **TOPCON**  
Precision Agriculture

[www.bourgault.com](http://www.bourgault.com)



# X30 System Components

## 7000 Series Leading Tank







Leading Air Seeder Tank

Implement

CM - 40  
ECU

3132-32



Safety Switch Jumper 3132-67

3132-79

Whisker switch  
Connect to Auto Clutch  
If no Blockage/ASC

3132-22

CAN2 Terminator 3132-65

3132-82

3132-27

Not Used

Fan1

Speed Fan1

3132-34

Case Drain

Fan 2

Speed Fan2

Ground Speed

3132-26

Keypad

3132-20

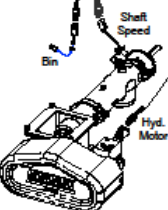

TANK 4

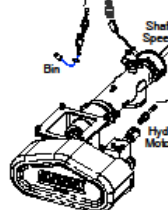

TANK 2

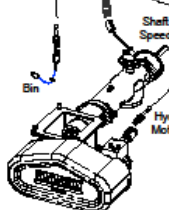

TANK 1

4 Tank Metering  
(T1, 2, 4, & T3 or T5)

To CH3  
on Main ECU

3132-20

To Bin  
Sensor

To Shift  
Speed  
Sensor

To Hyd.  
Motor

Tank 3 or Tank 5

5 Tank Metering  
(T1, 2, 3, 4, & 5)

CM - 40  
ECU

3132-32



To CH1 on  
2nd Master ECU

3132-20

To Bin  
Sensor

To Shift  
Speed  
Sensor

To Hyd.  
Motor

Tank 5

Caps for Unused  
ECU Harness Connectors

3132-84

3132-85

3132-86

3132-82

CAN2 Terminator 3132-65

Whisker switch  
Connect to Auto Clutch

3132-78

CAN1 Terminator 3132-09-03

Safety Switch Jumper 3132-67

IF NO  
Blockage or ASC

3132-80

CAN1 Terminator 3132-09-03

3132-65



## Cross Tank Harness

Bourgault Part # 3132-79  
Topcon # 1004997-01

Back of the machine connections

Aux Power: not  
used

Whisker plug: connect to  
Auto clutch if no  
blockage/ASC

The Tractor end hooks into  
the ISO plug and the power  
harness.

ECU Breakout: hooks to the  
breakout harness then to the  
ECU's

Safety Switch plug needs to have this  
jumper plug on it or you will loose  
communication with the ECU's.

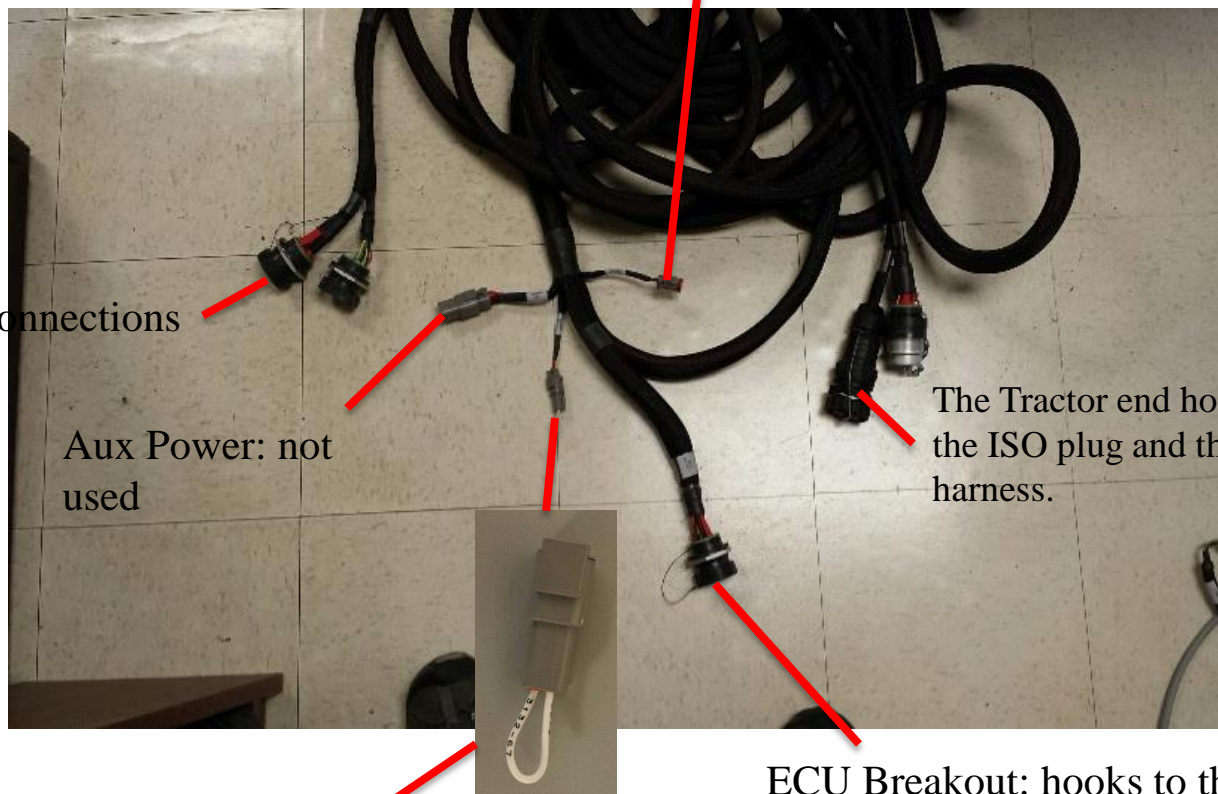



## Breakout Harness

Part # 3132-83

Topcon # 1005038-01

Can 2 should have a terminator  
plug on it

Hooks to main tank harness.

Keypad: hooks to the extension  
harness (3132-27) that goes to  
the calibration keypad

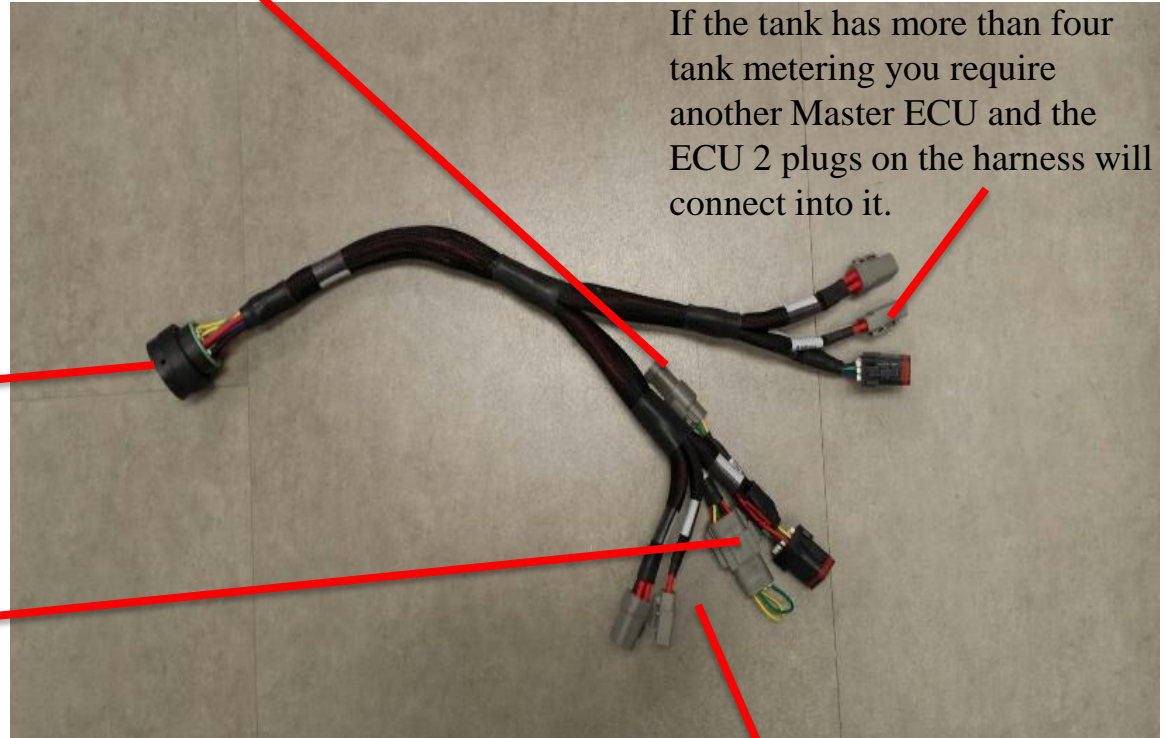

If the tank has more than four  
tank metering you require  
another Master ECU and the  
ECU 2 plugs on the harness will  
connect into it.

Three connection Comms, power  
A, and Power B hook to the  
Master ECU.



One Master ECU configured for 4 tank metering. No sectional control or NH3 or liquid



If tank has five tank metering a second Master (CM-40) needs to be added in. Or if the tank has four tank meters and NH3 or liquid.





## Master ECU (CM-40)

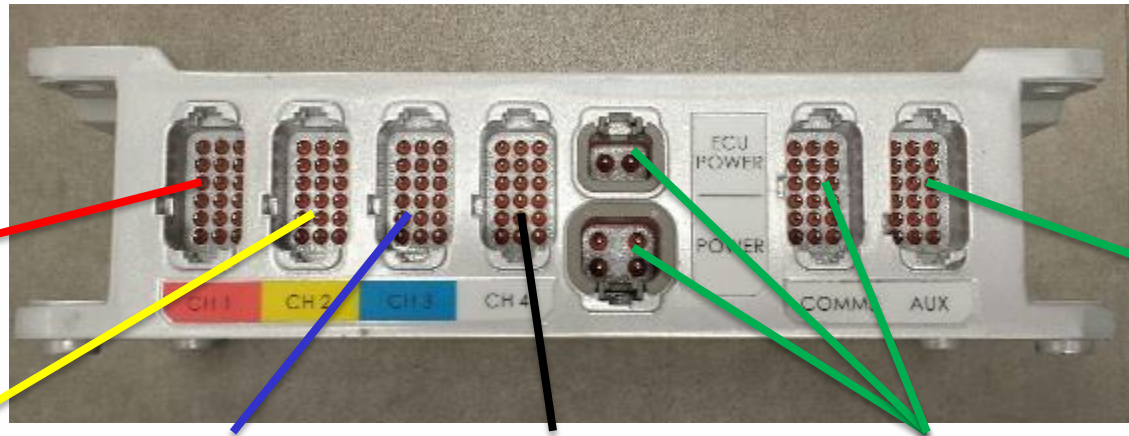

AUX – fans and ground speed control

These three get plugged into the main breakout harness 3132-83.

Note: if the tank has more than four tank metering a second Master ECU is needed. The control for the fifth meter will then come from CH 1 on the second Master.

Part # 3132-32  
Topcon #100452-01



## Metering Harness

Part # 3132-20

Topcon # AGA5515

This harness is the same for all the metering systems

- Connects to the control valve on the metering auger.
- Connects to the speed sensor
- Connects bin level sensor



Connects to one of the CH plugs on the Master ECU (CM-40)





## Speed Sensor



There are speed sensors in several locations on the air seeder. These include fan speed, ground speed, and metering auger speed. All of these sensors are proximity style and send a signal to the ECU.

- the **fan speed sensor** picks up from a target bolt on the fan hub (one pulse per revolution).
- the **ground speed sensor** is located on the rear left wheel mount or drive. It picks up a signal from a sprocket

## Bin Level Sensor



Each air seeder compartment that has a metering auger contains a single bin level sensor installed near the bottom. The sensor will trigger an alarm when there is no product in front of it.

Part number 3132-17

Topcon # AGA5478



## Auxiliary Harness

This harness extends from the Master ECU out to the fans, ground speed and the case drain sensor.

- Connects to the AUX plug on the Master ECU
- Hook to the ground speed sensor on the back left wheel.
- Fan one connection.
- Fan two connection.
- Case drain sensor wire.

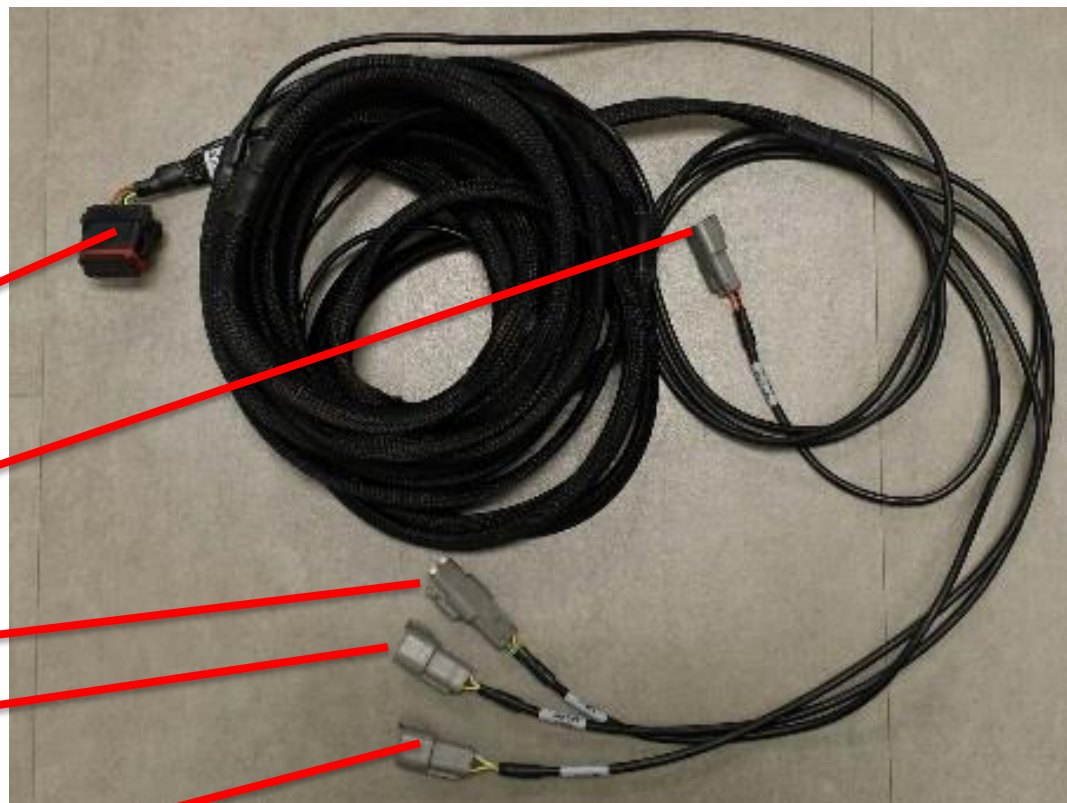

Part # 3132-22  
Topcon #AGA5510



## Calibration keypad Extension harness

Part # 3132-27

Topcon # AGA5514

- Plugs into the breakout harness right at the Master ECU



- Plugs into the back of the calibration keypad.







## Tow Between Terminator Harness

Part # 3132-80

Topcon # 1005028-01

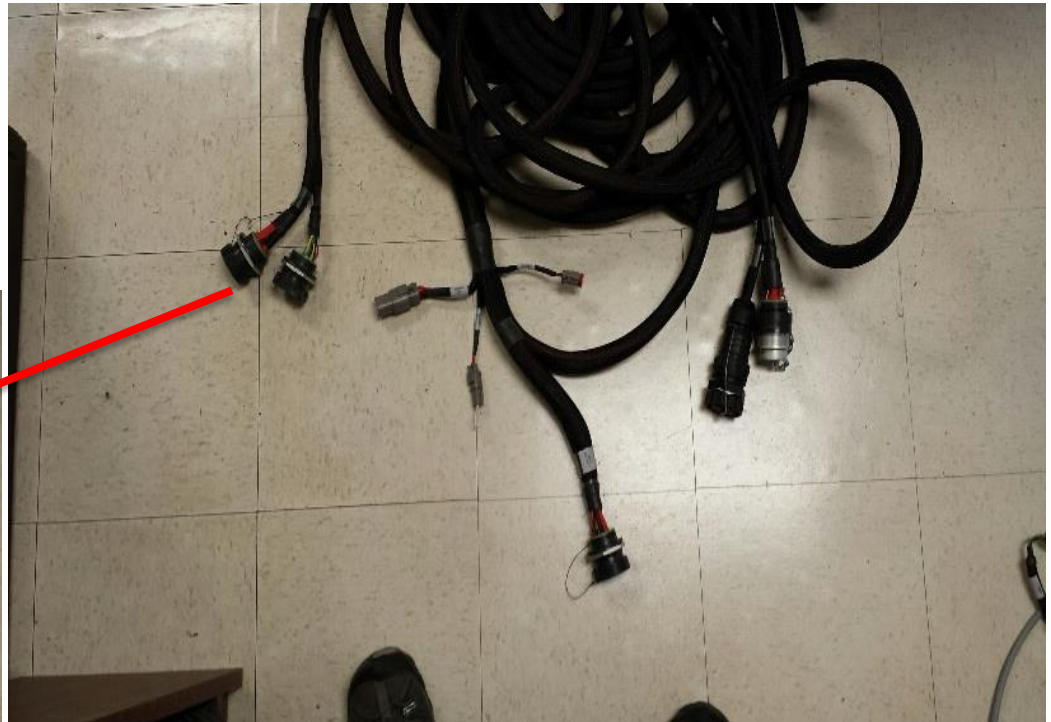
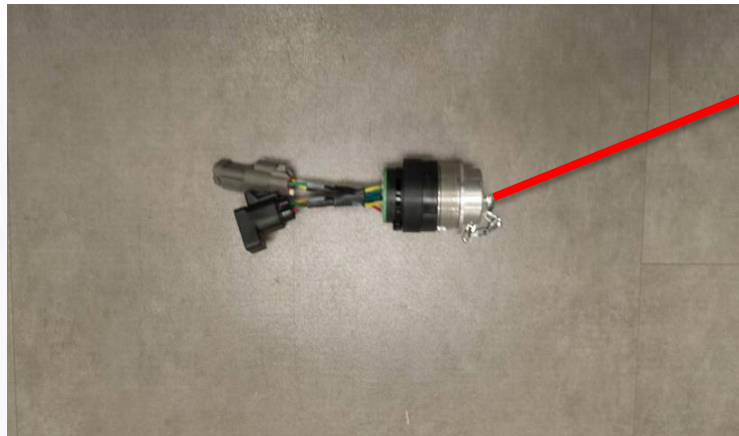

Note: This harness needs to be in place if there is no Blockage or sectional control on the drill