



**How to set up NMEA output from a Trimble 262 receiver with
a Pro 600/ Intelliview Plus II using cable Trimble part number
55224**



Connect to the 262 receiver like as in this picture

262 Trimble
Antenna

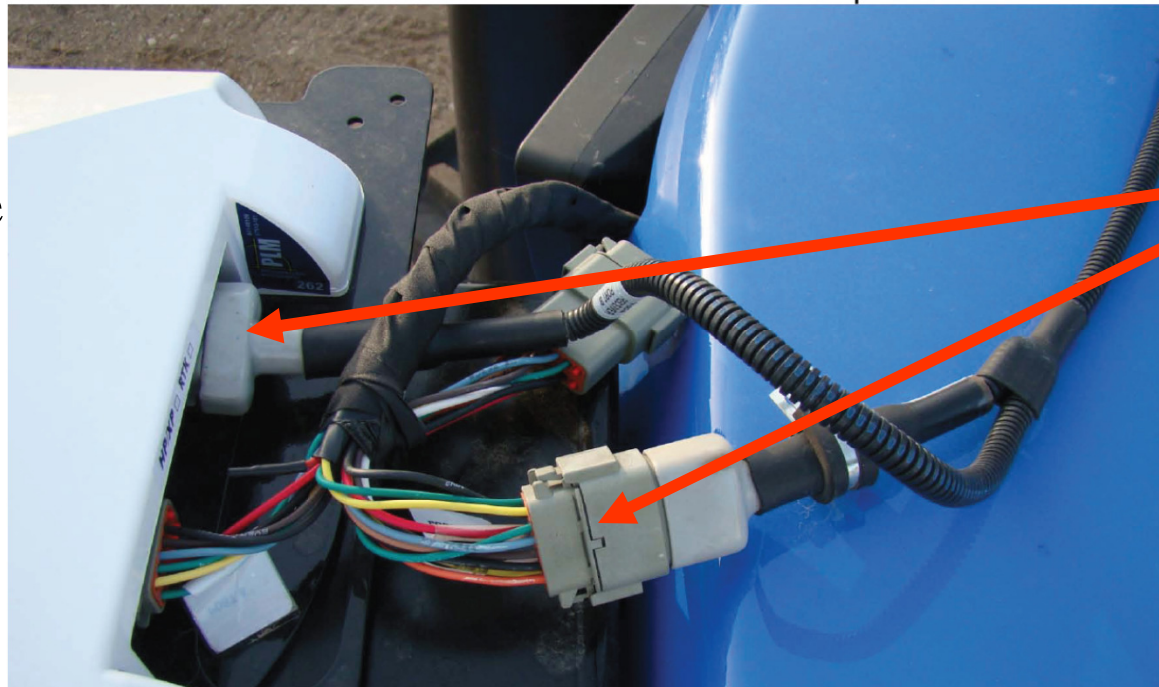

55224
Trimble
part #

The other end of the cable plugs into the Y cable supplied with the X-20 monitor that is connected to Coms 1 and 2 on the X-20 monitor.

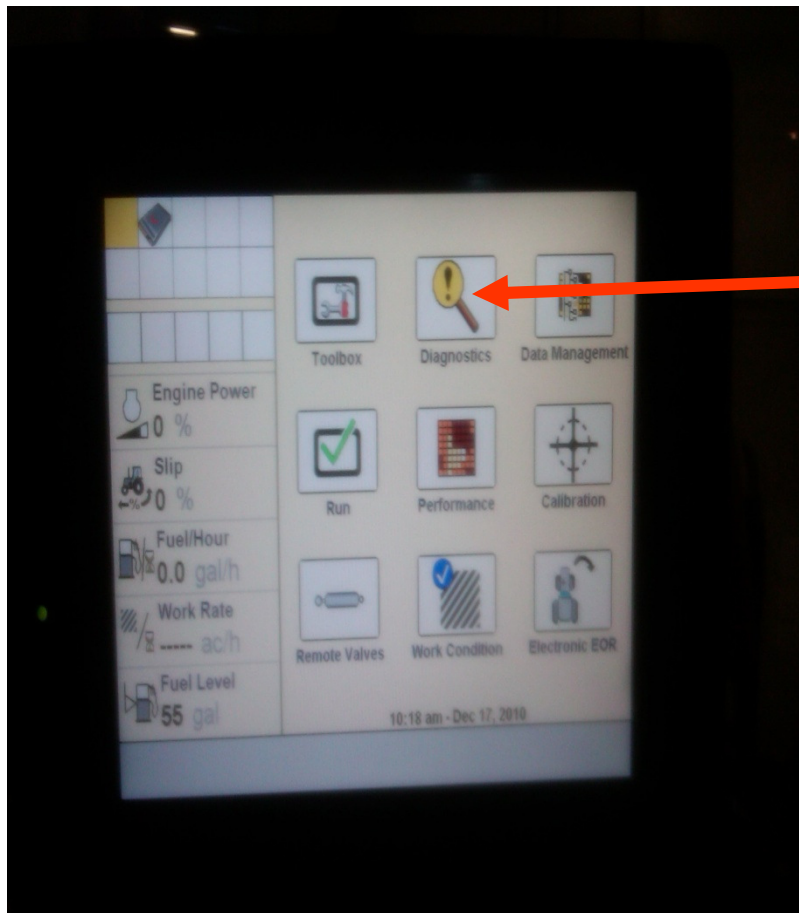

From the main screen press the diagnostics button

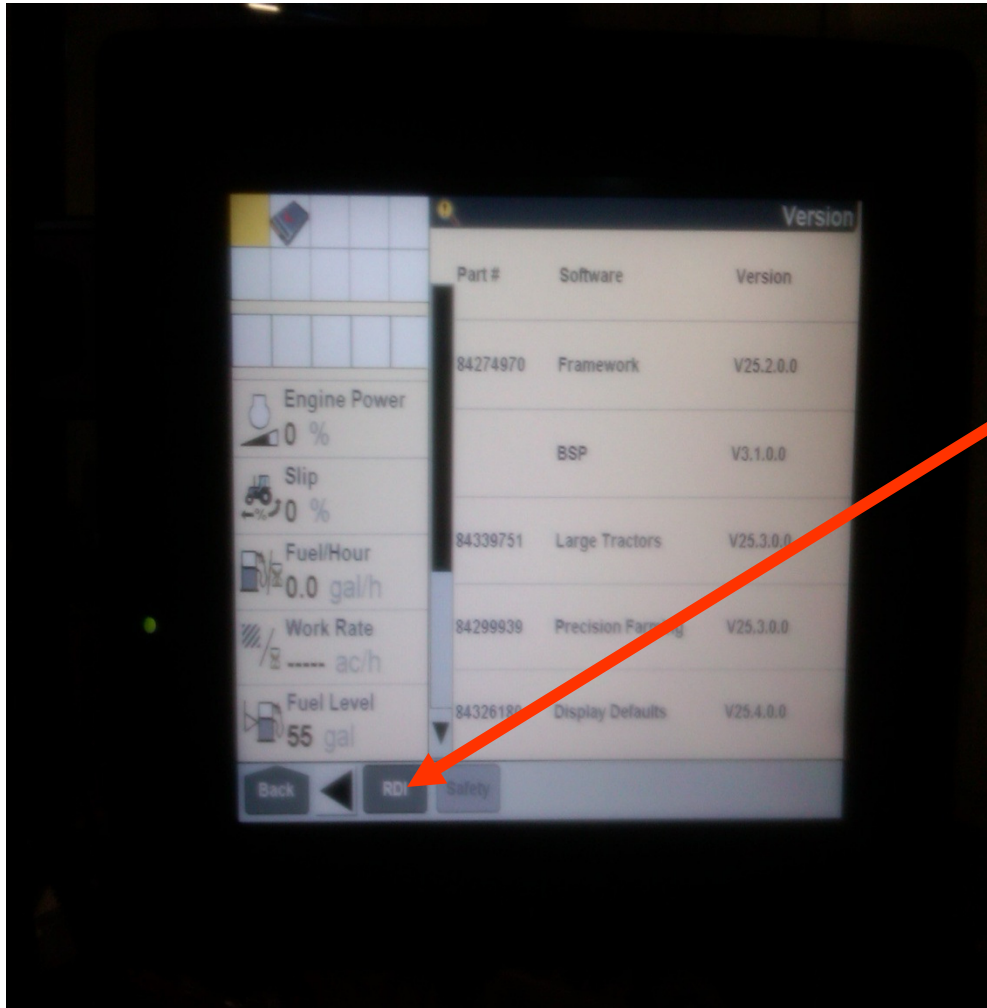

Scroll to right and press the RDI tab

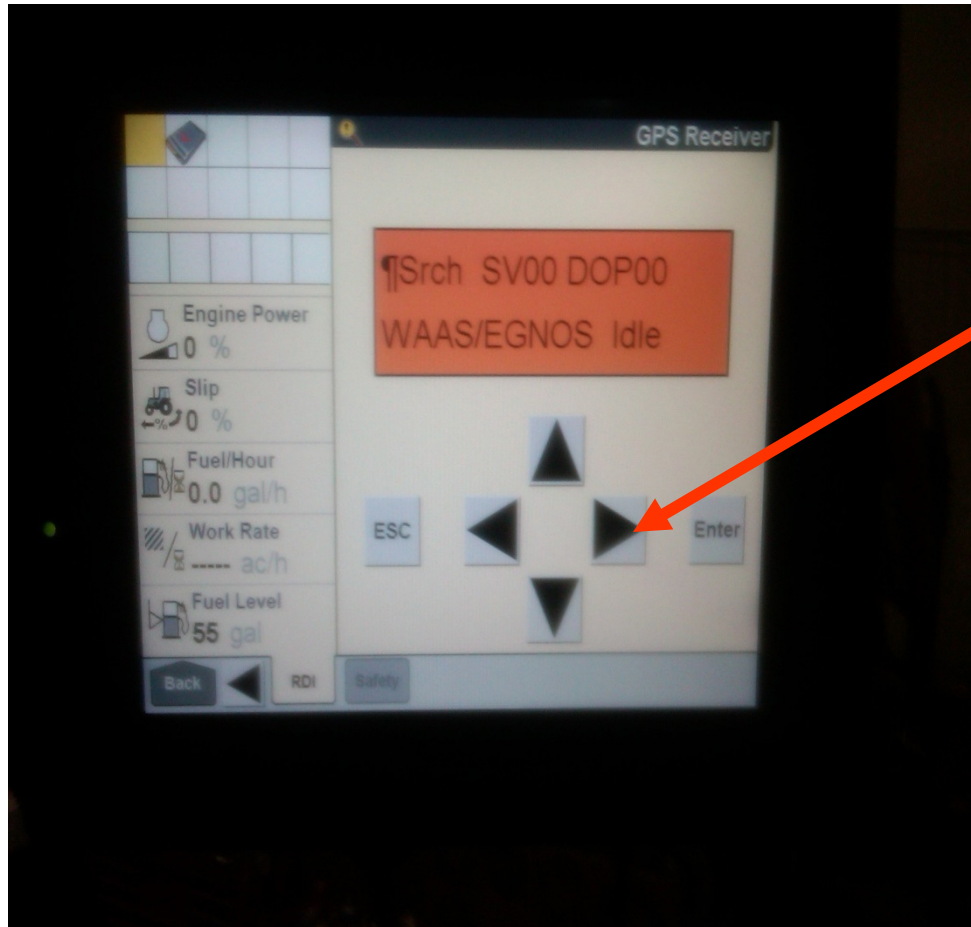

Press the right arrow

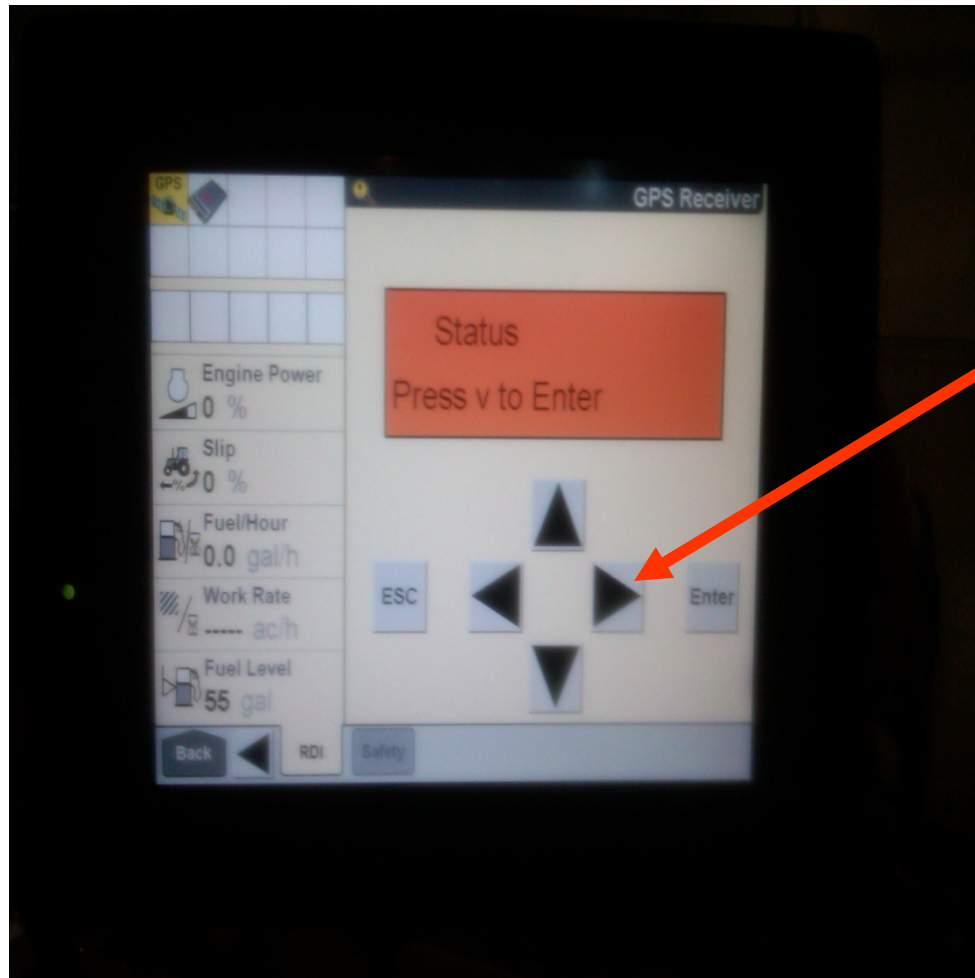

Press right arrow again

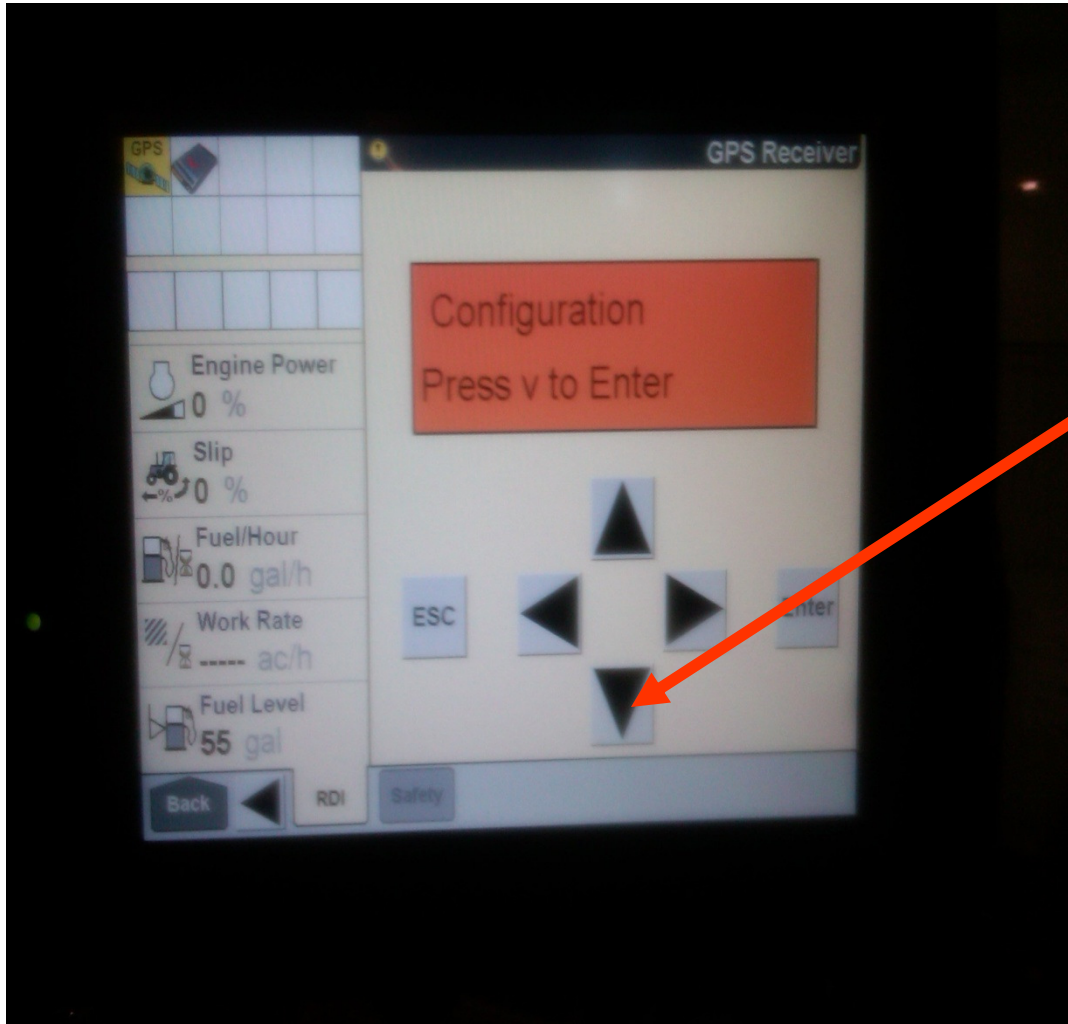

Press down to enter the configuration menu.



Press right arrow

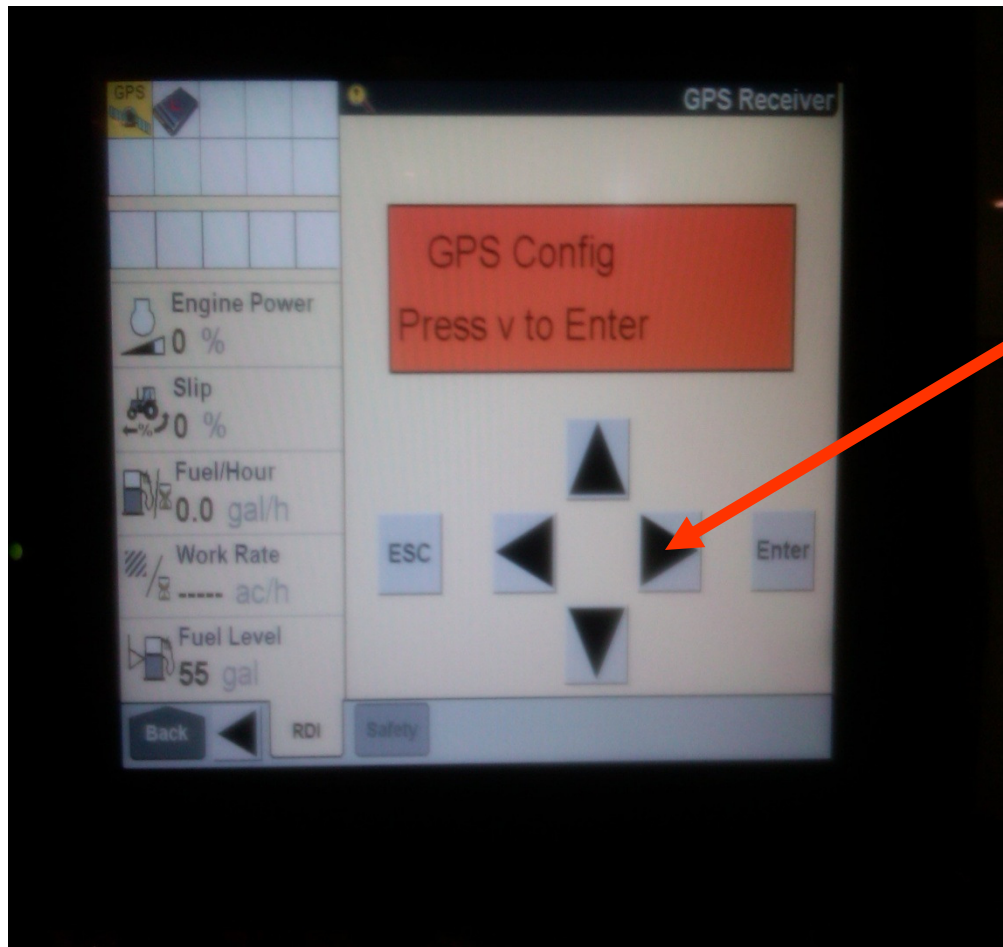

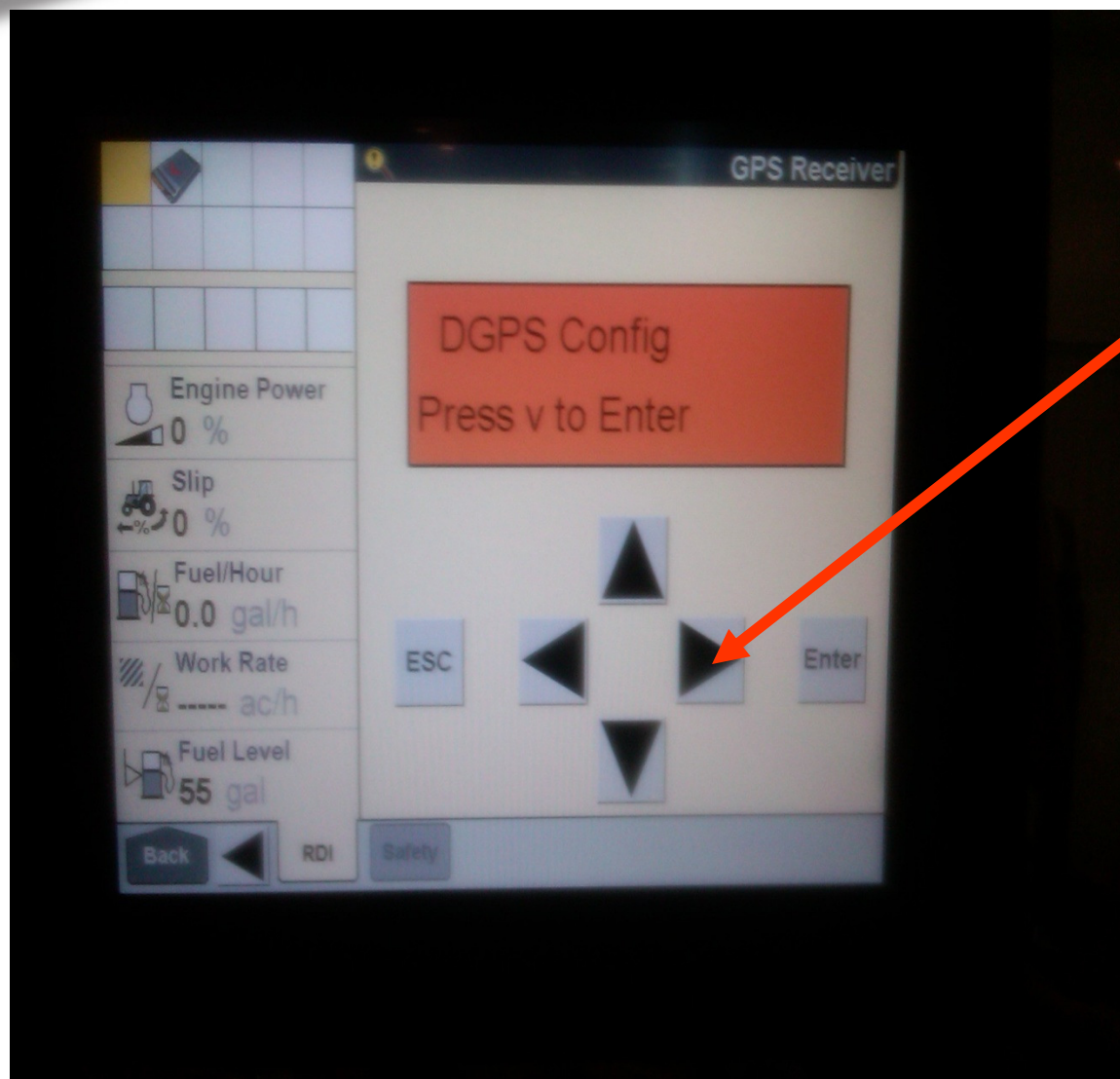

Press right arrow

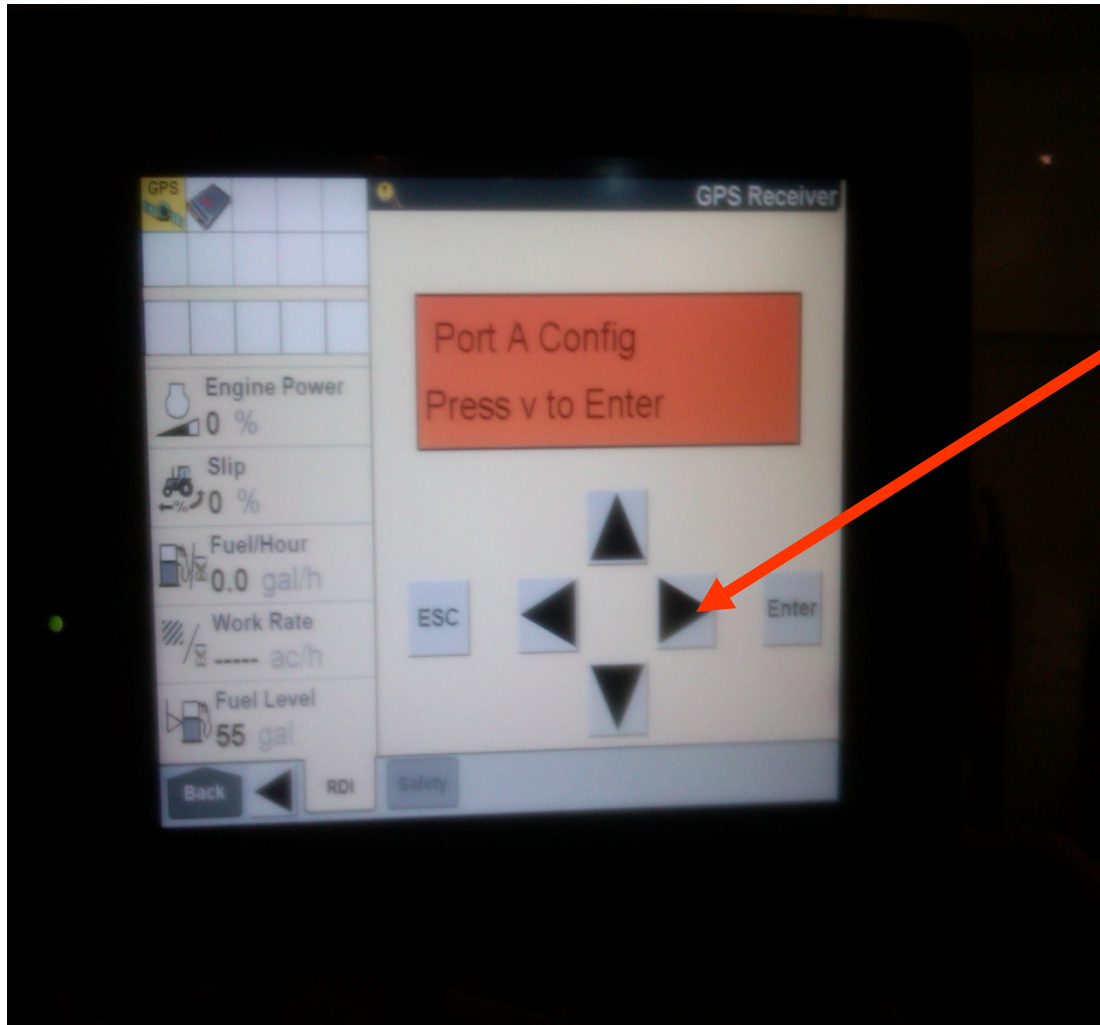

Press right arrow

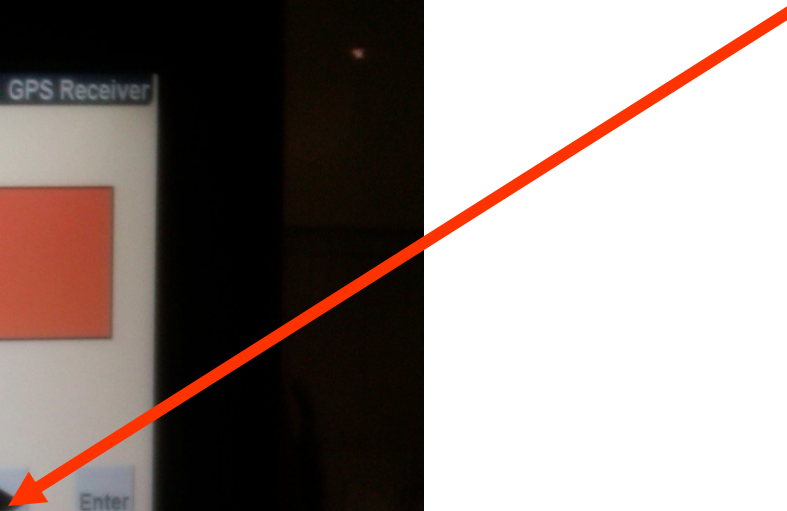

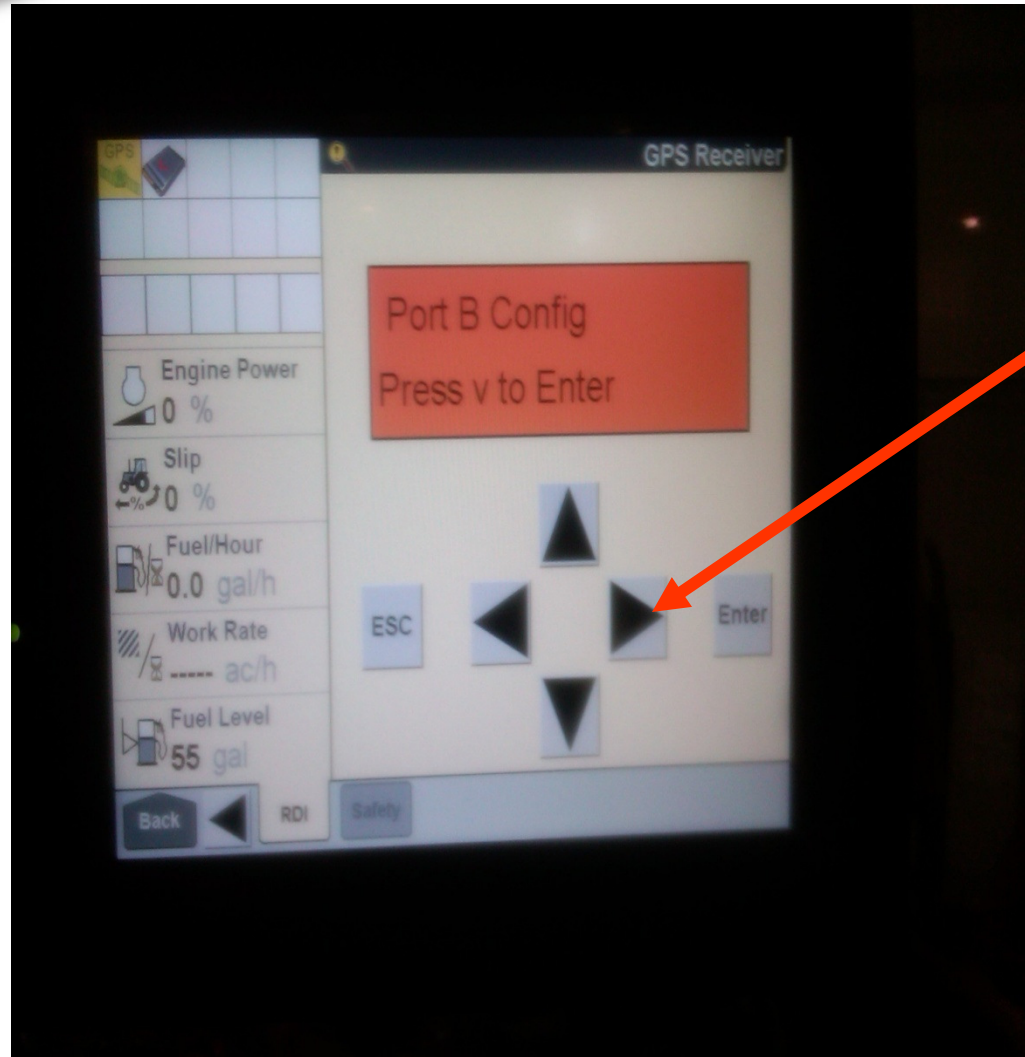

Press right arrow

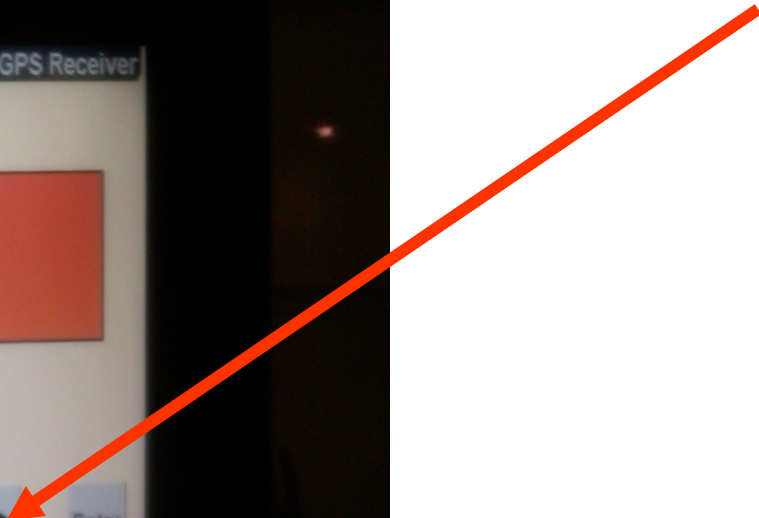

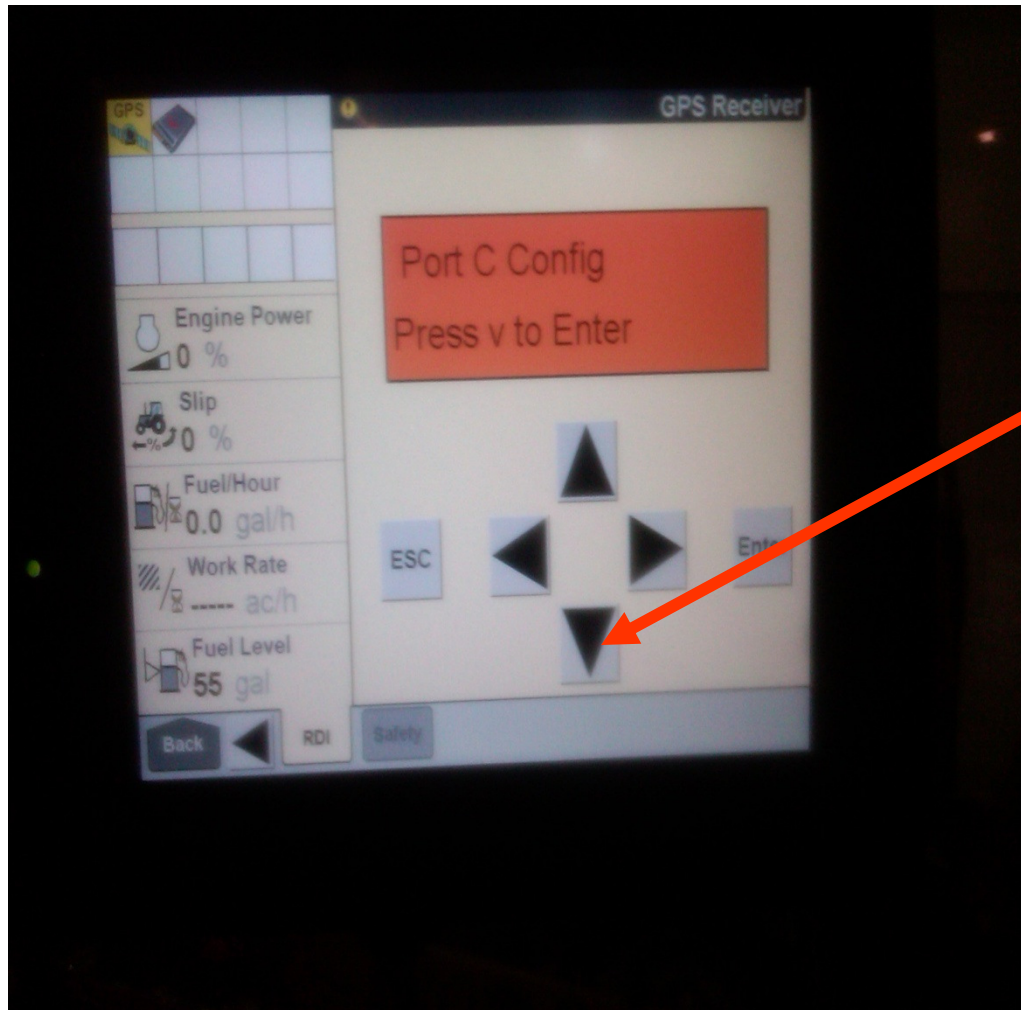

Press down to enter port C configuration

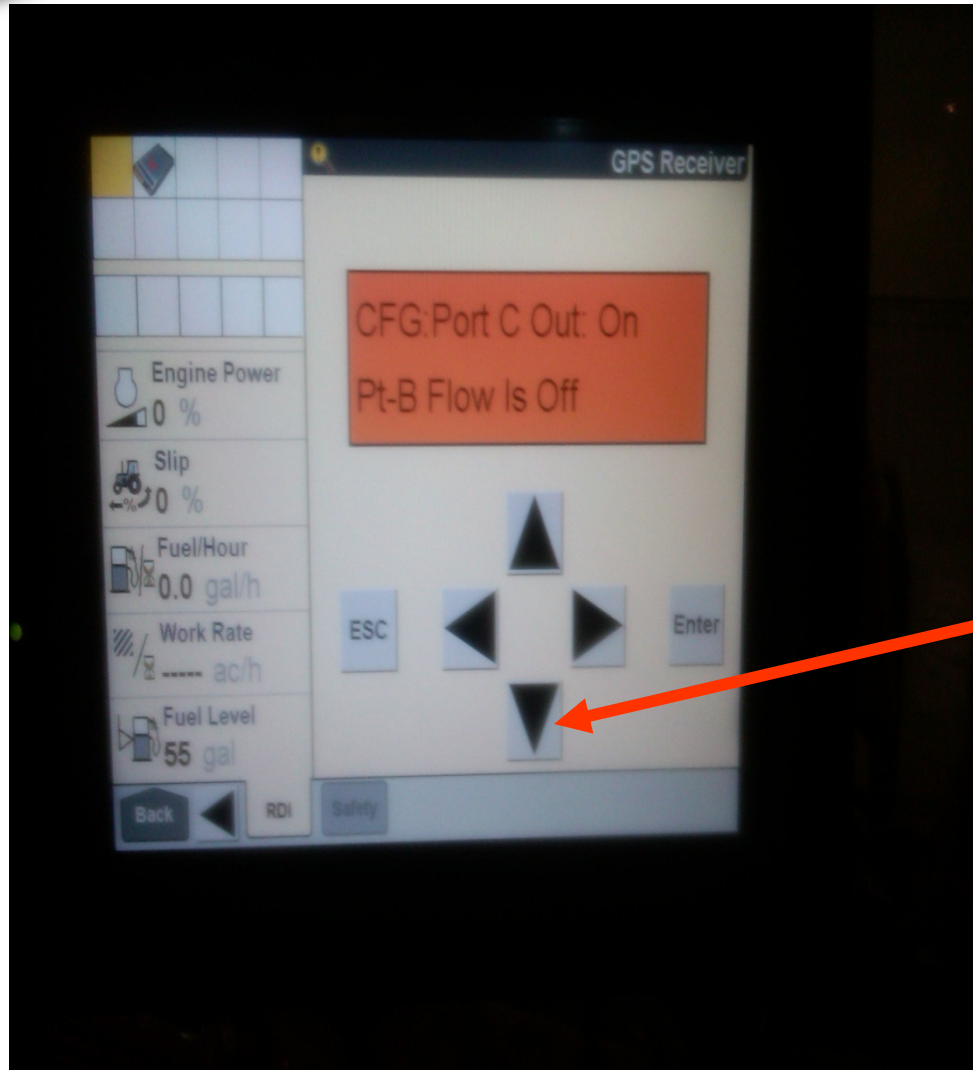

This page should be telling us that Port C out is on and that Port B flow is off and this will be the proper configuration. **If it is different press right, then up and then enter.**

Next press the down arrow.

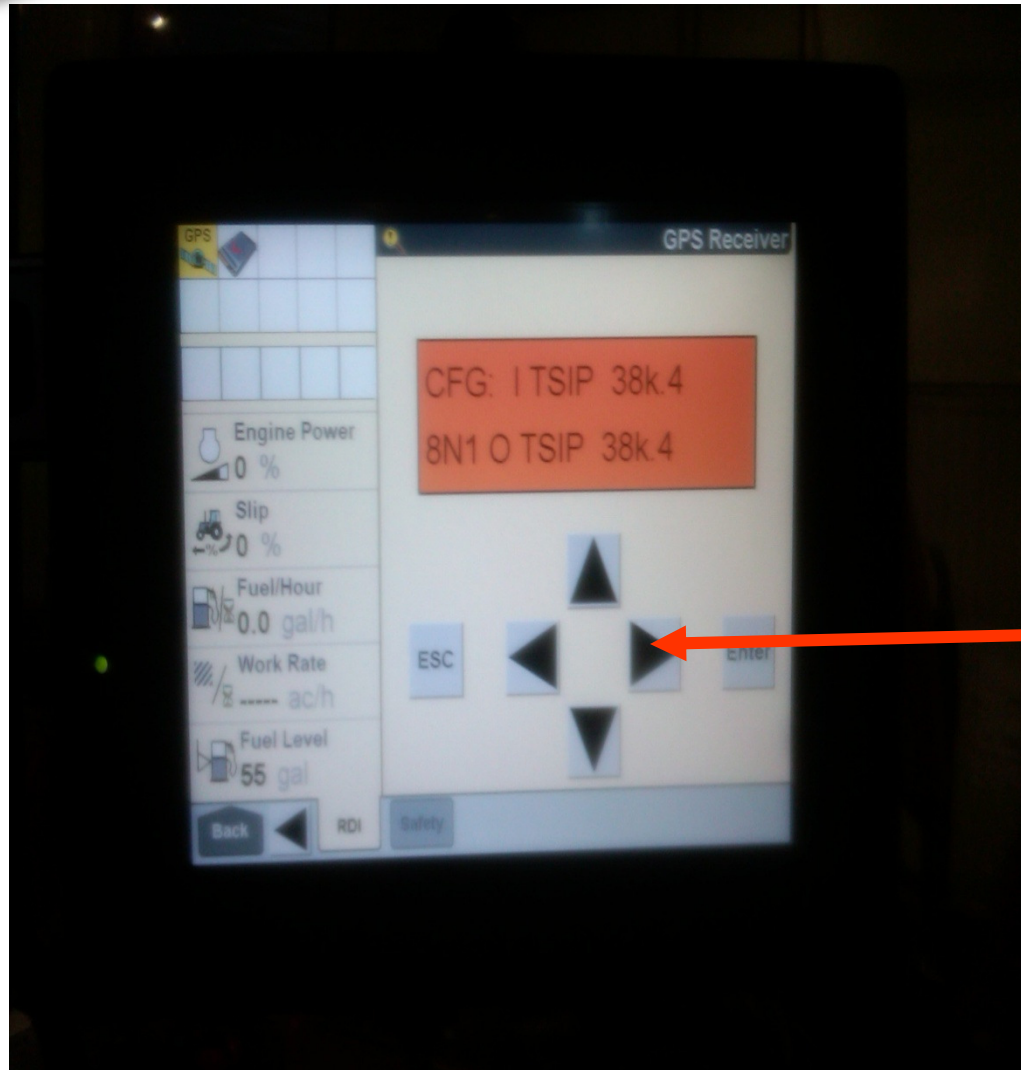

On this page we want to see
I TSIP 38k.4

8N1 O NMEA 38k.4

If we don't have this we
need to re-configure. Press
the right arrow.

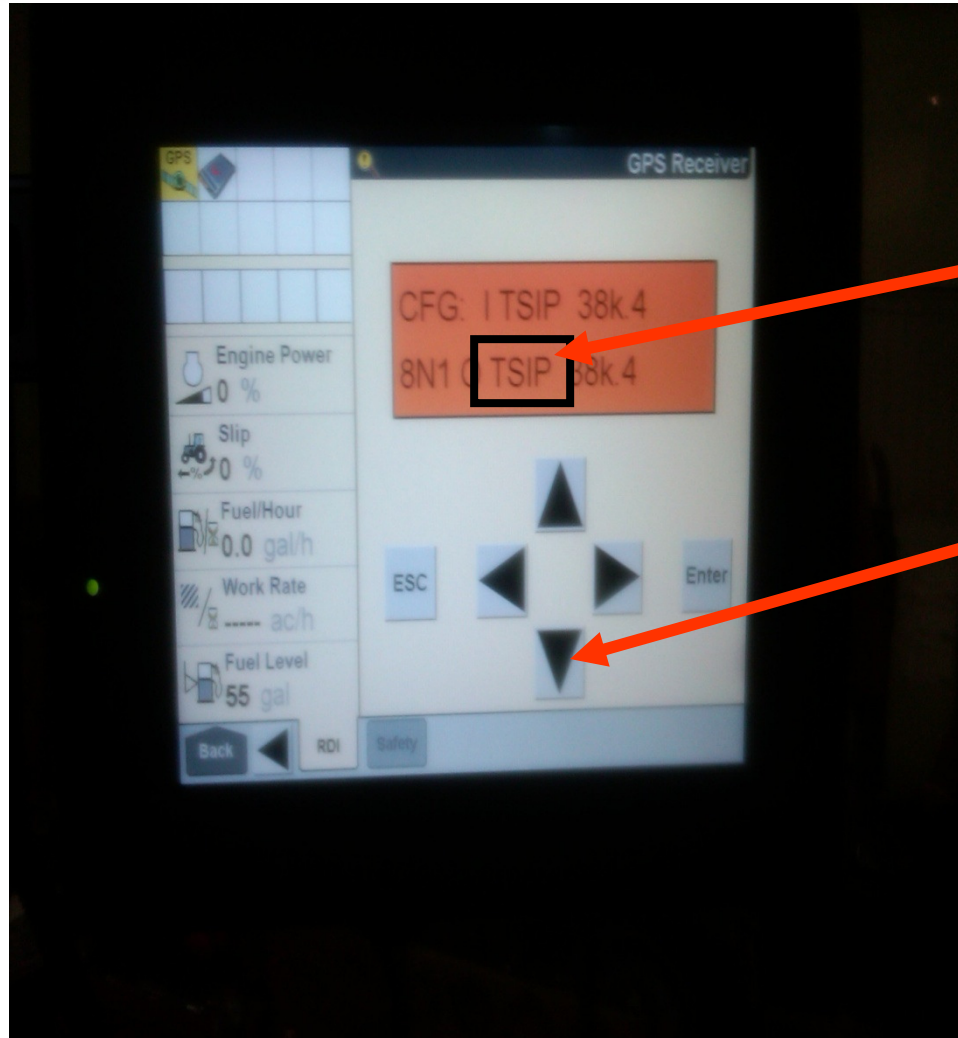

Press right arrow until TSIP
on the lower line is flashing

Next press the down arrow

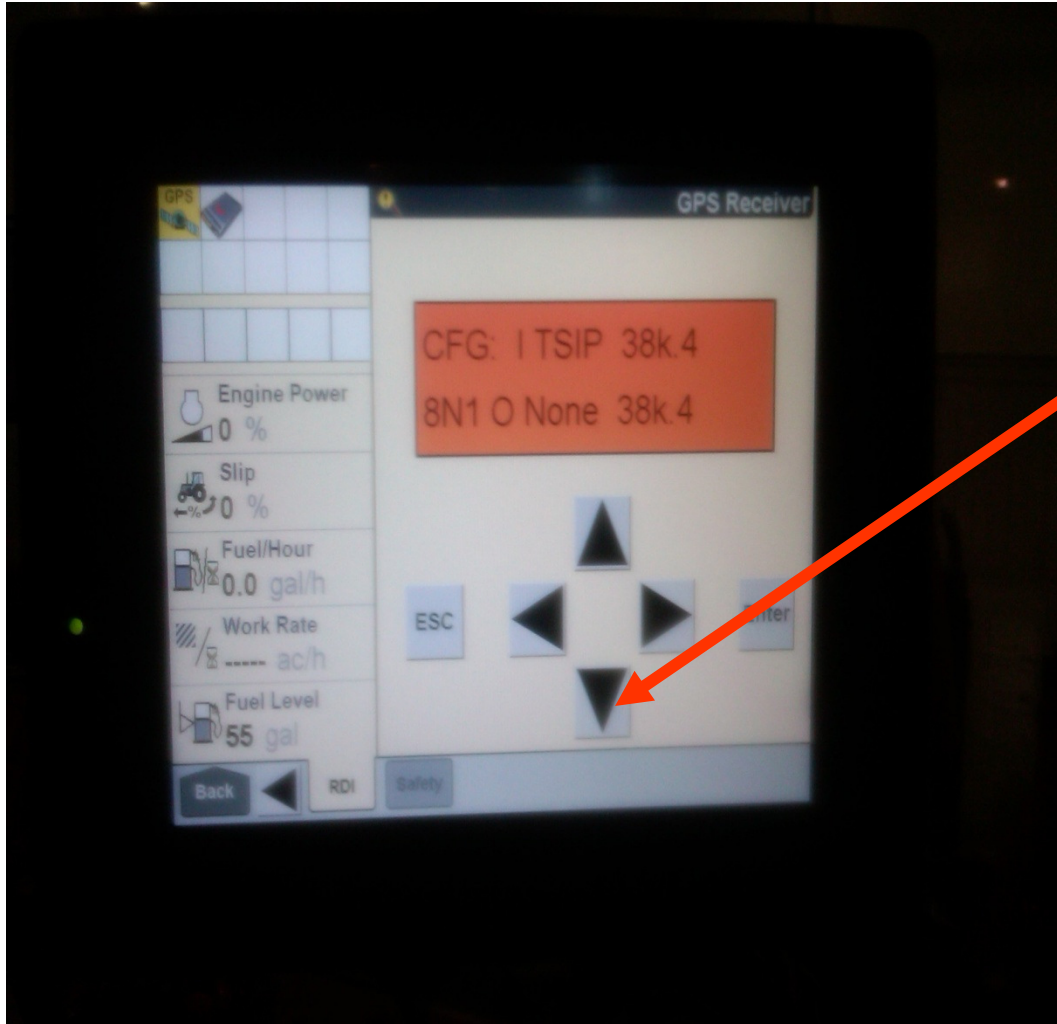

Press down arrow



Press down arrow

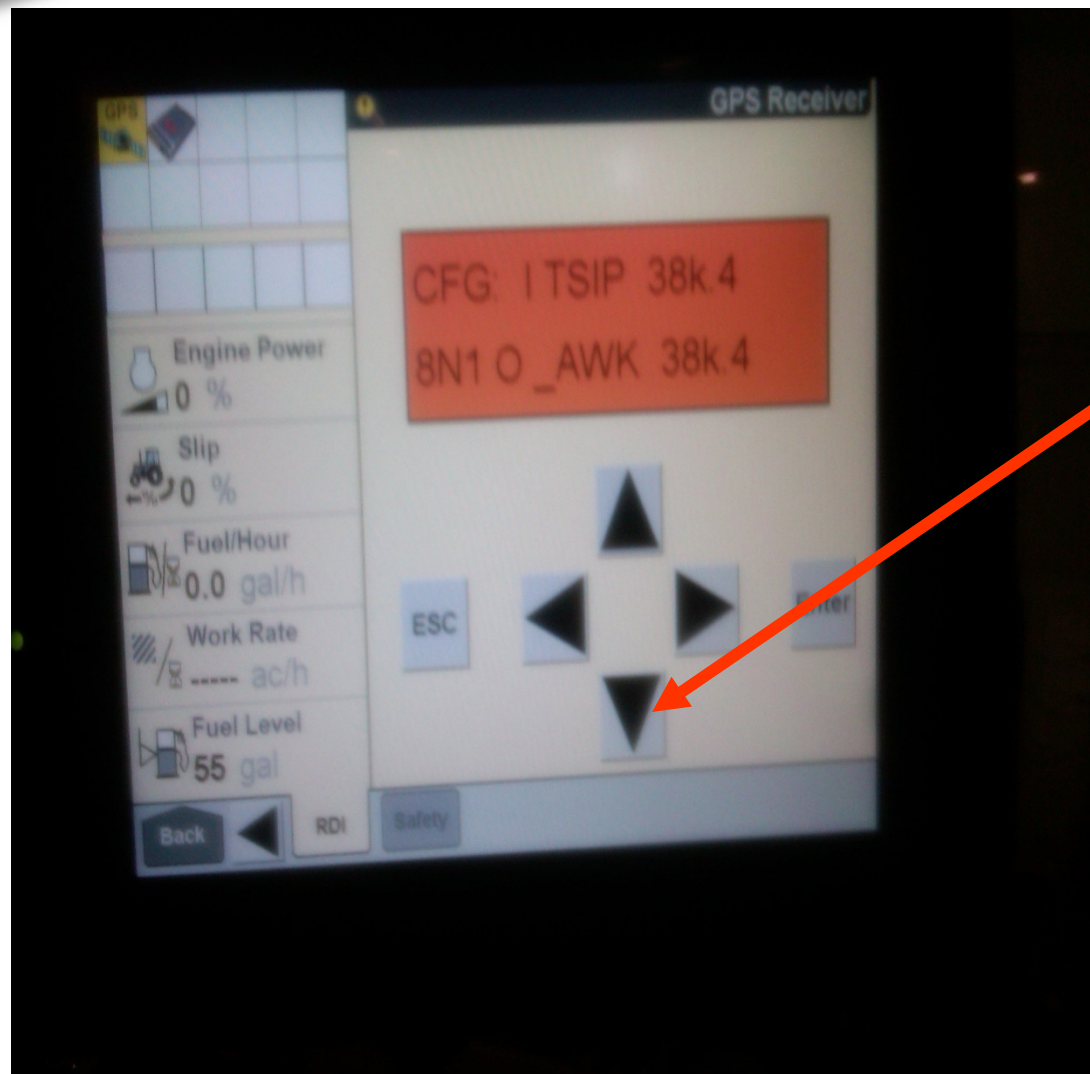

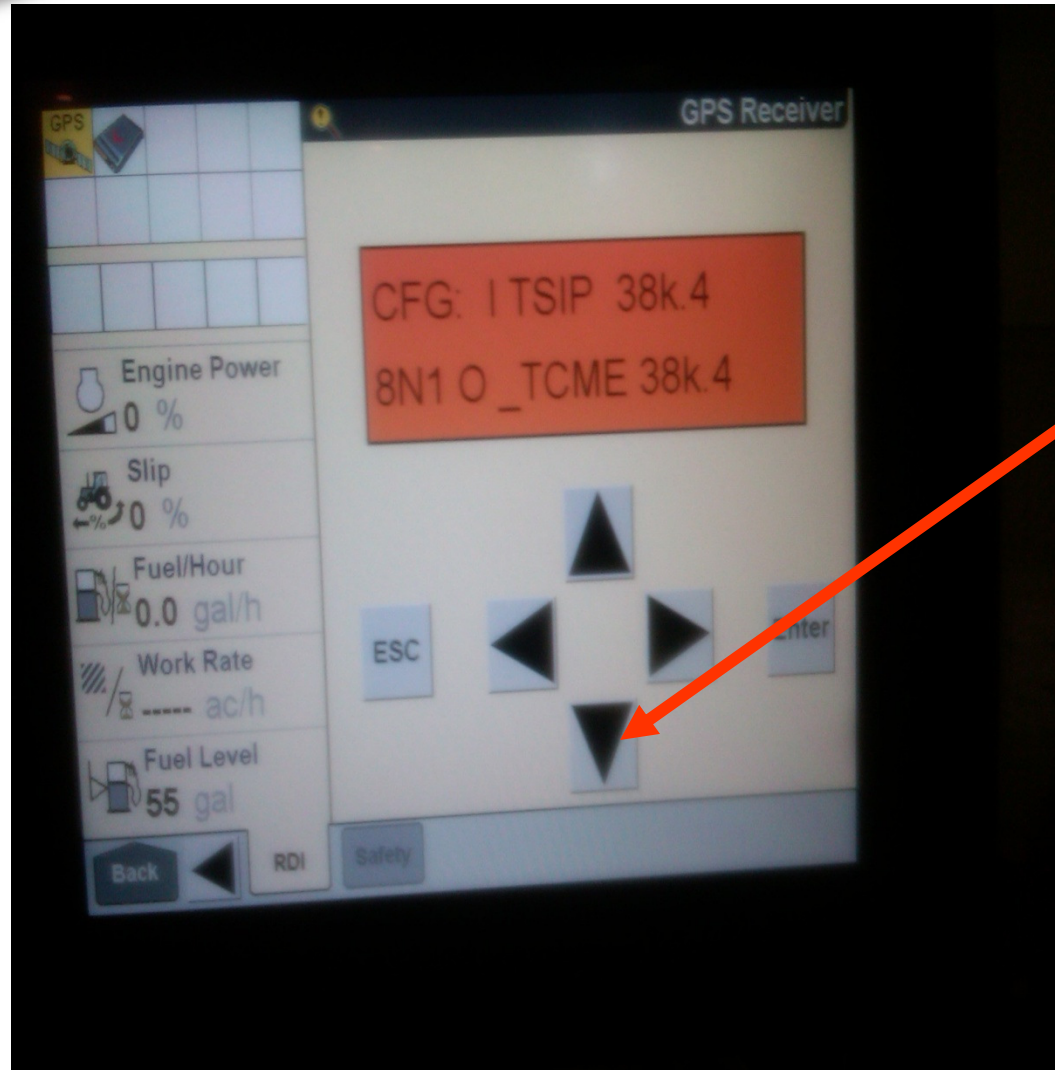

Press down arrow

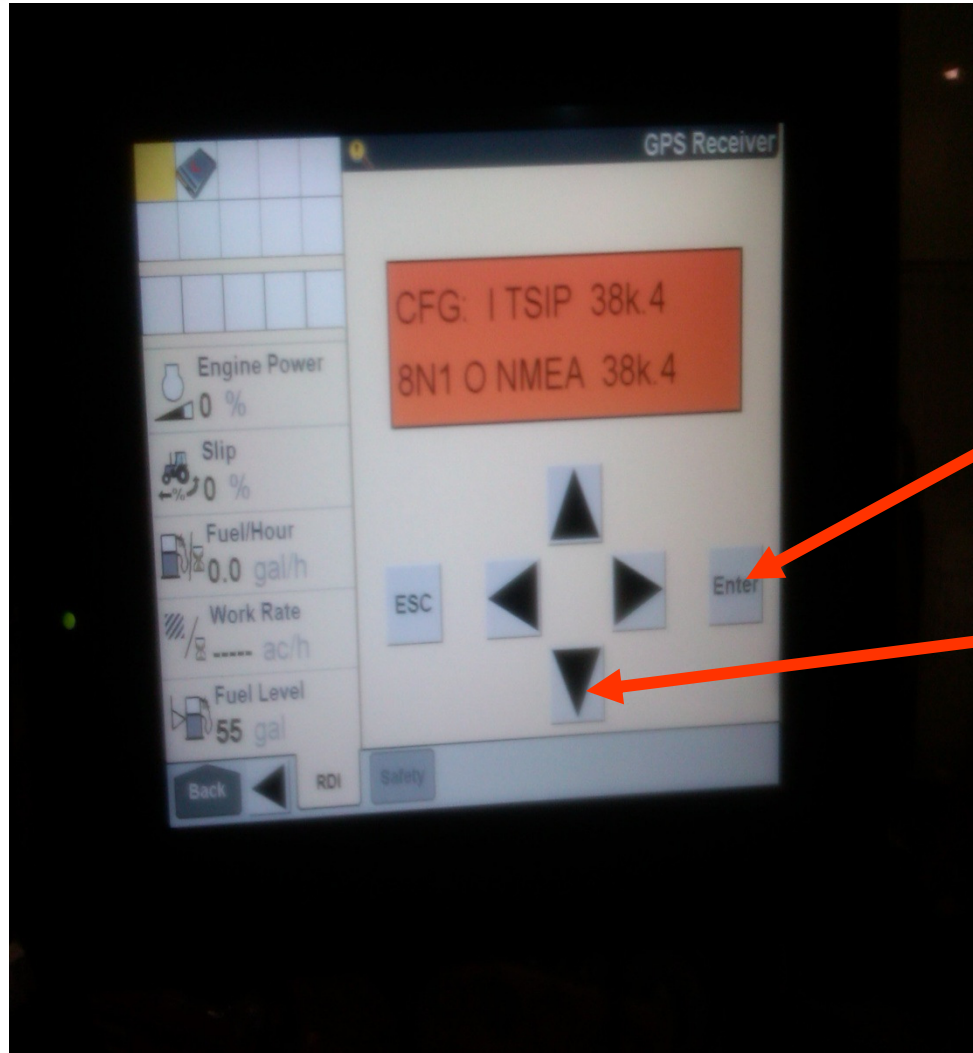

Once you have NMEA displayed press enter.

Next press down arrow

2011

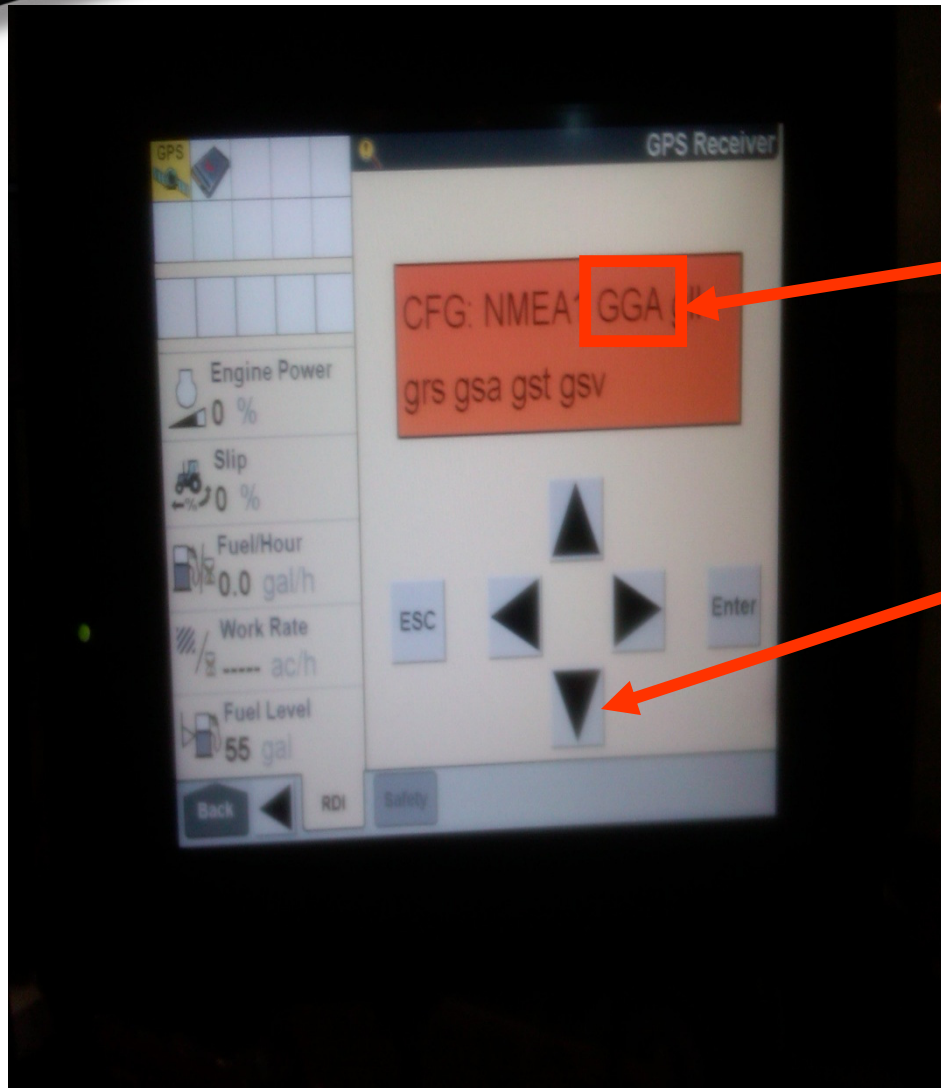

On this screen the GGA should be in capitals

Next press down arrow.

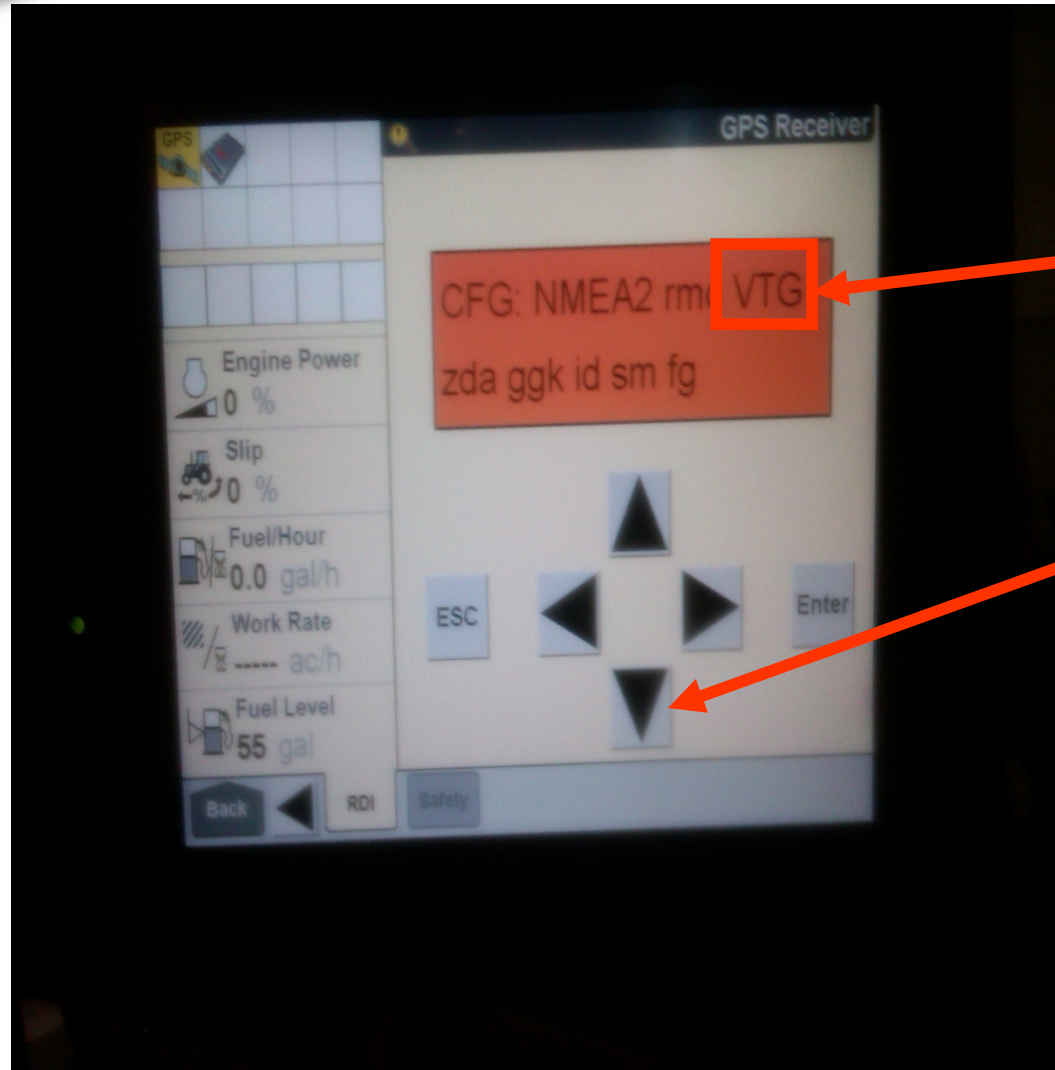

On this screen ensure that VTG is in capital letters.

Next press the down arrow

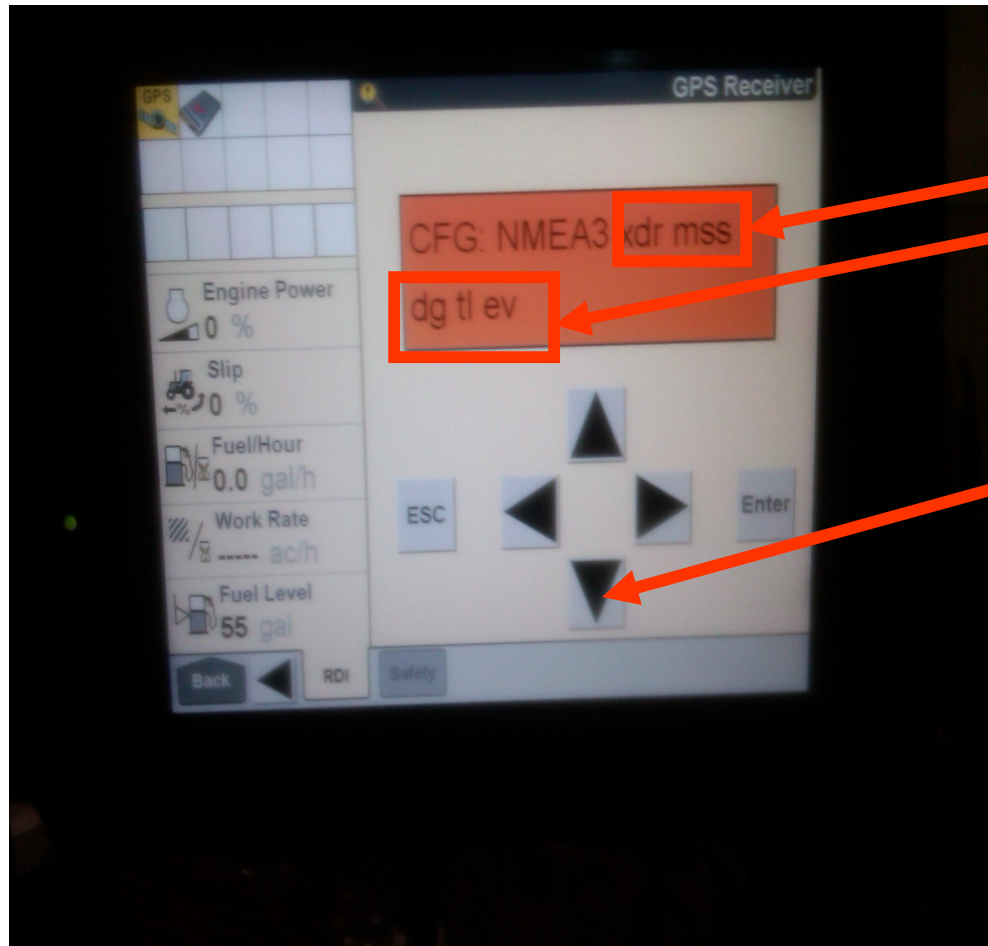

All lower case on this page.

Next press down arrow.

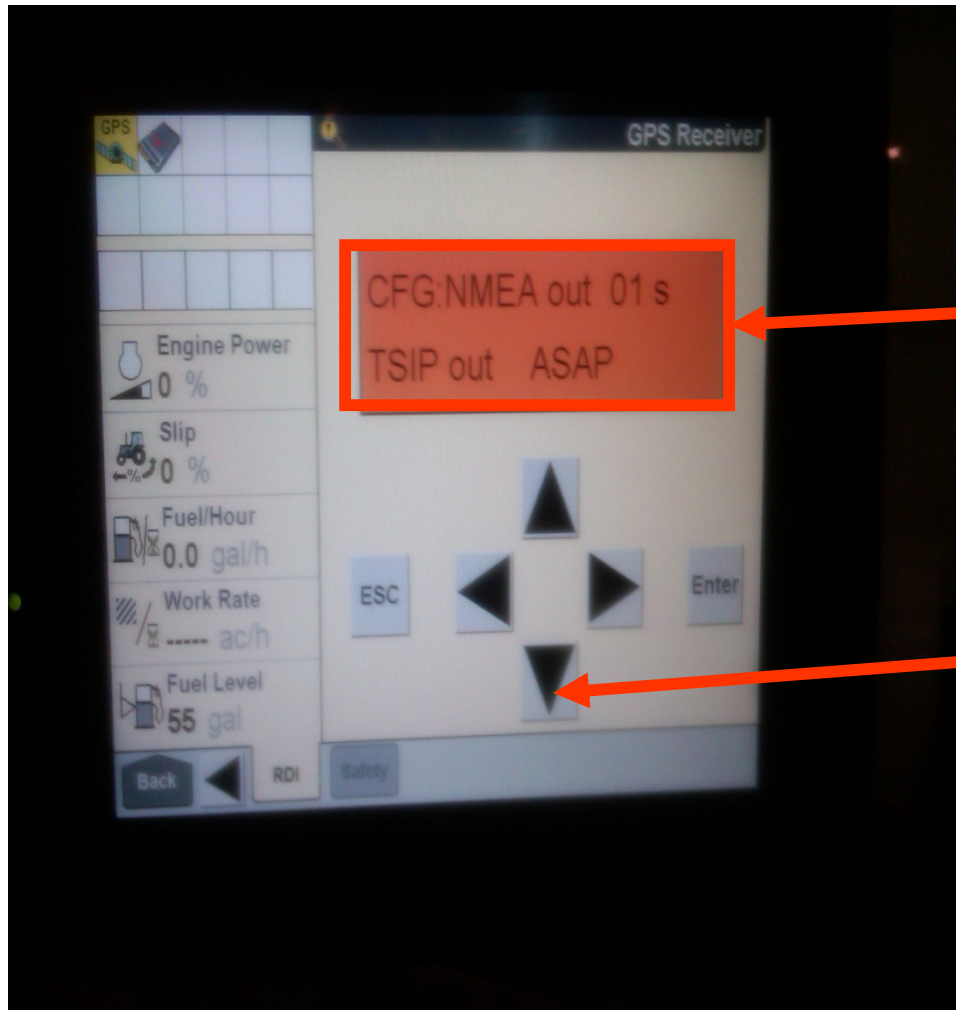

This page should look like this

NMEA out 01 s

TSIP out ASAP

Next press down arrow.

2011

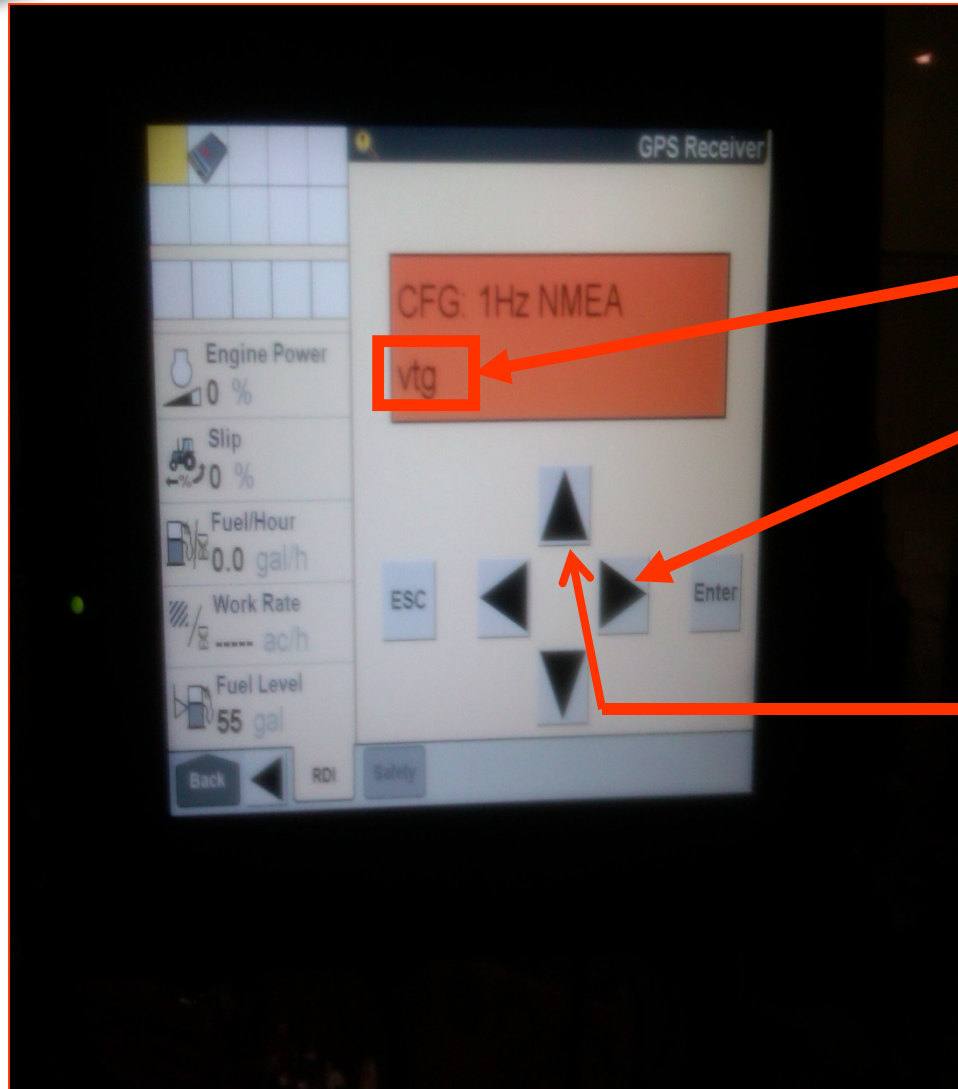

On this page VTG should be in capital letters.

To get this press the right arrow

Next press the up arrow

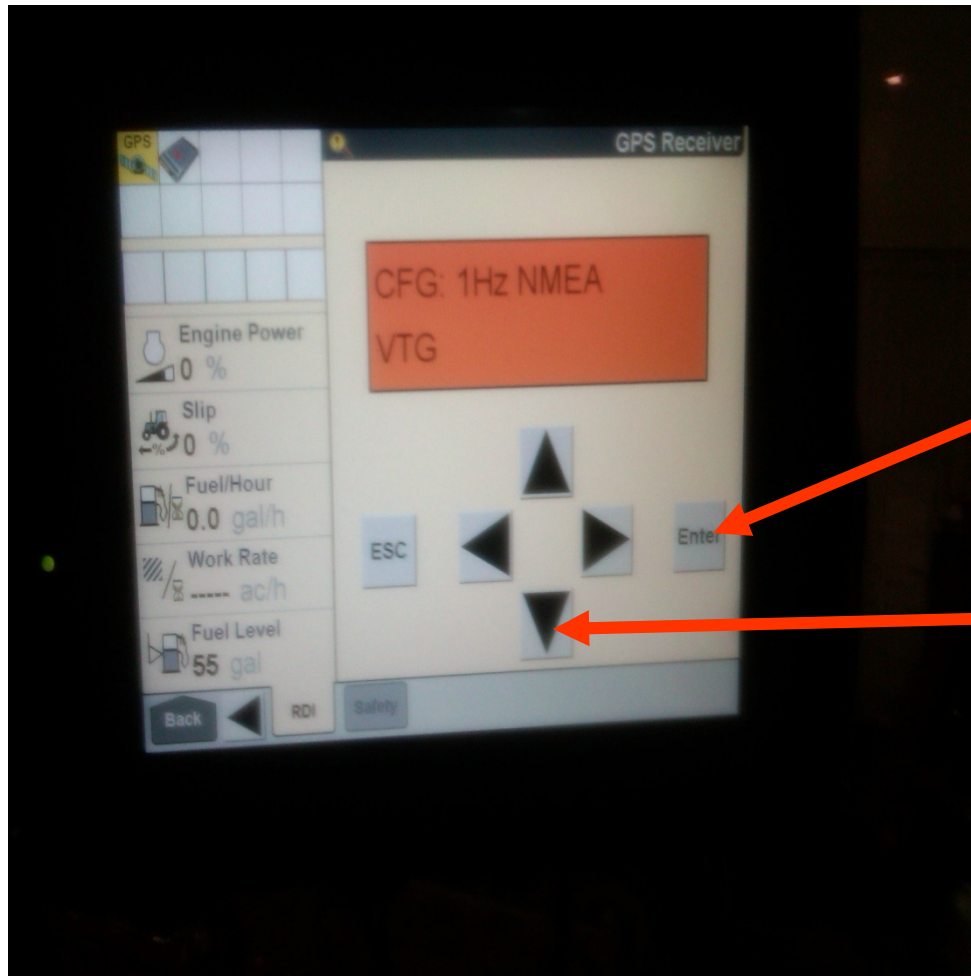

Press the enter to lock the VTG in capital letters.

Next press down arrow

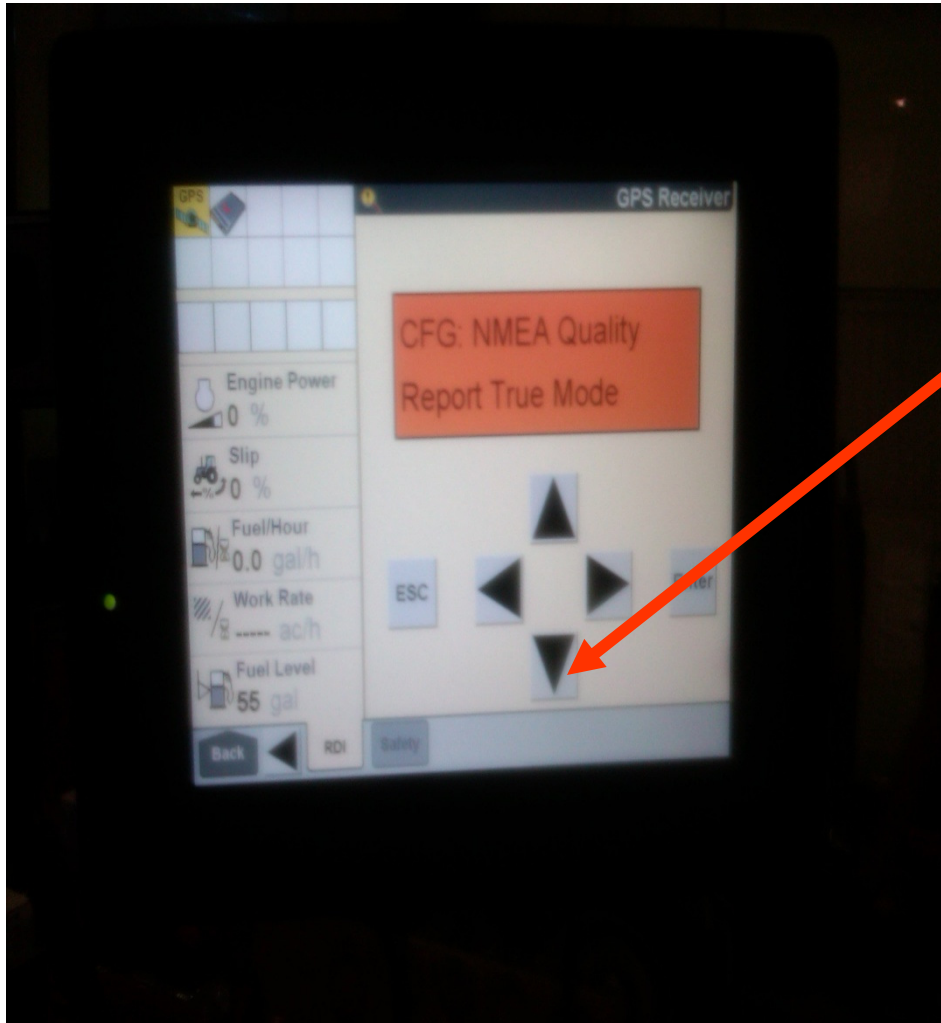

Press down arrow

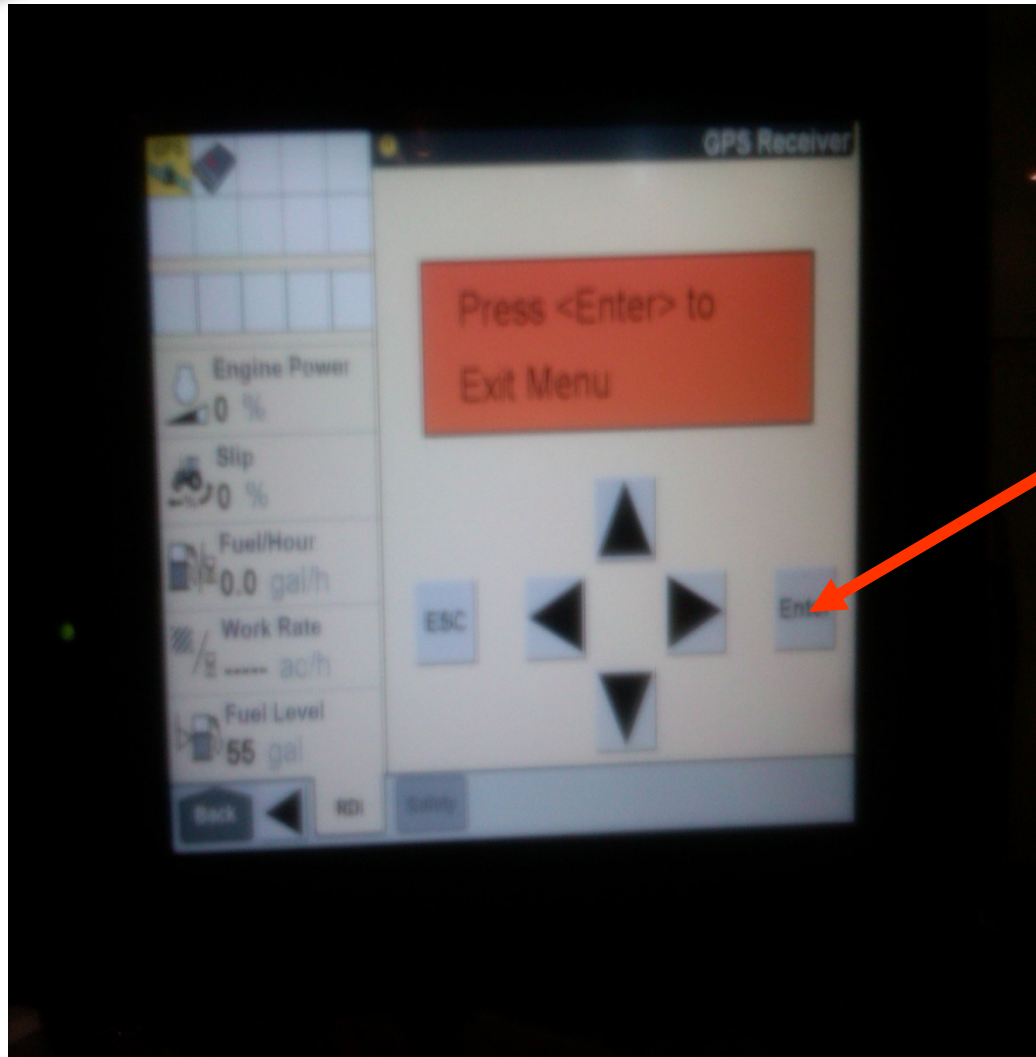

Press the enter key to exit set-up



Press ESC to exit to home screen

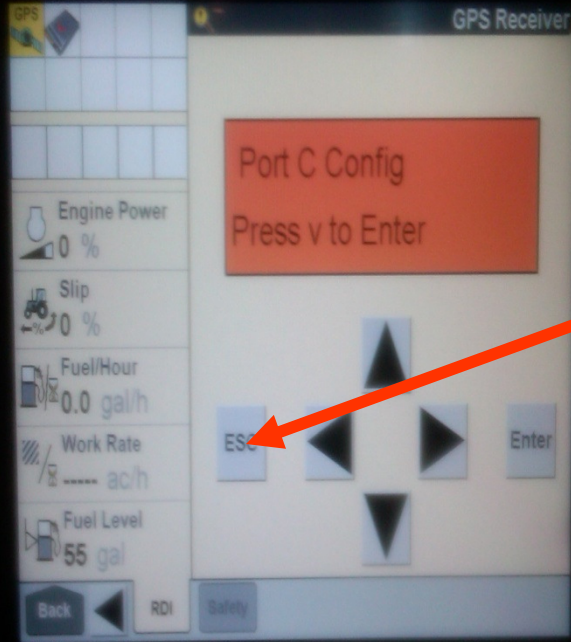

20 View from the back of the Topcon X20

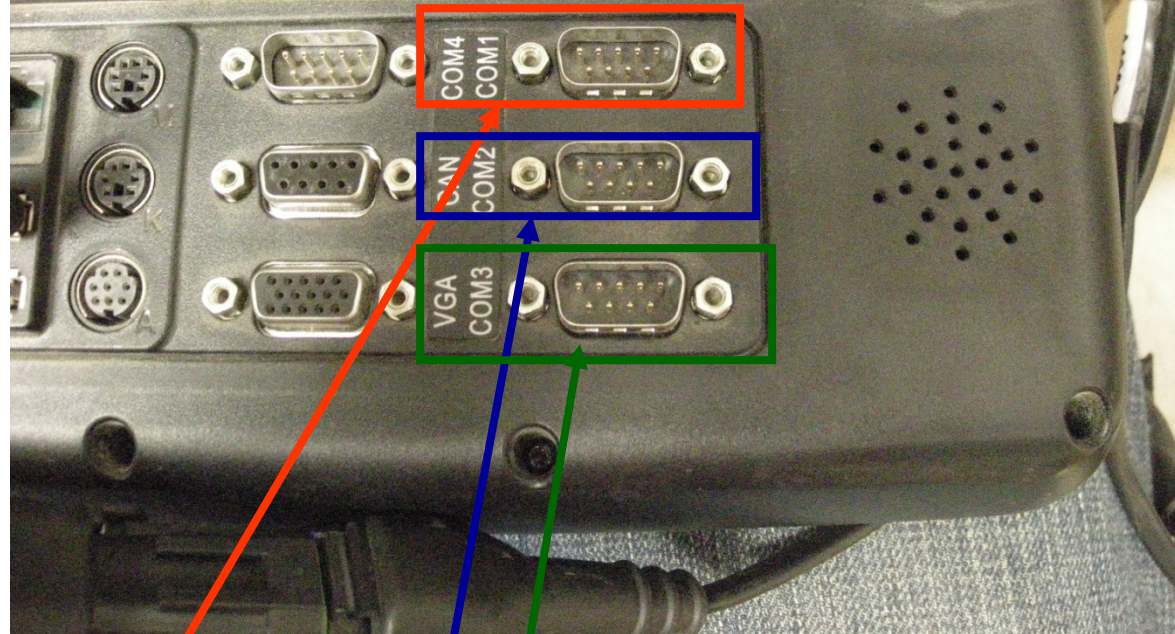

All serial cables must be connected to specific COM ports.

- **Guidance to COM1 (To serial port on Trimble)**
- **Variable Rate Control to COM2 (To serial port on Trimble)**
- **Seed Rate Control to COM3 (To SRC interface box)**

2011

To COM1 port of X20

To COM2 port of X20

3131-07 Y cable

To GPS Receiver

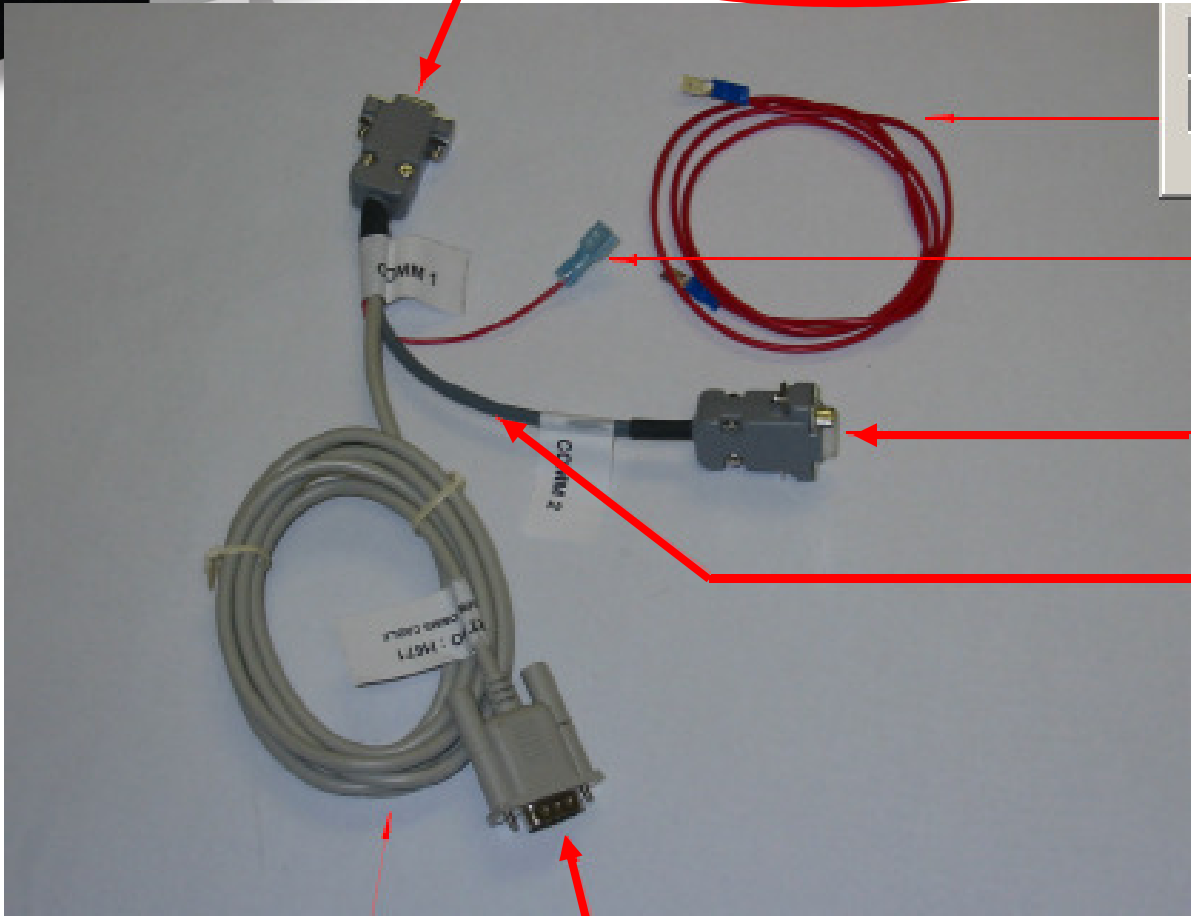

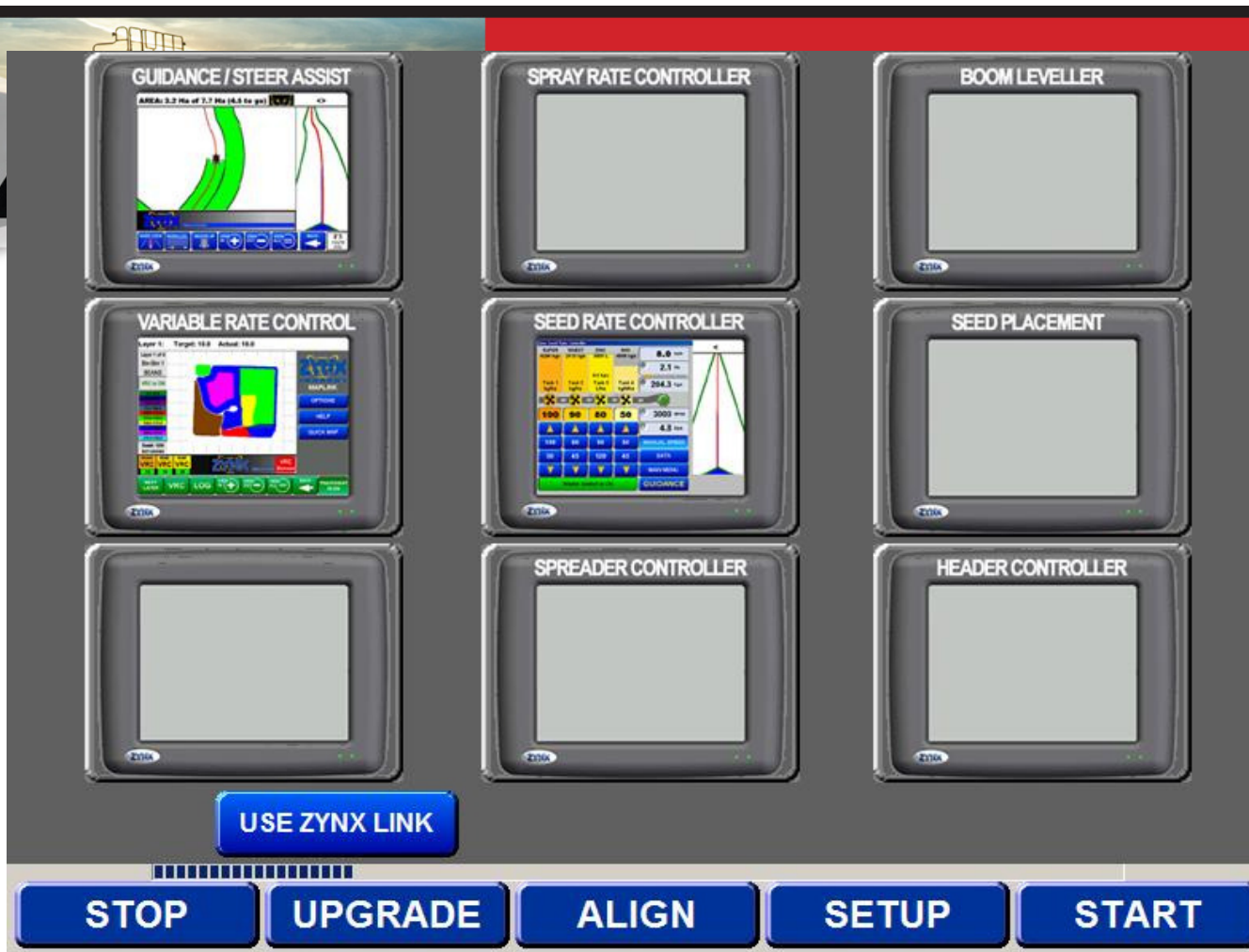

Power up the X20 and select Guidance/Steer Assist, Variable Rate Control and Seed Rate Control.

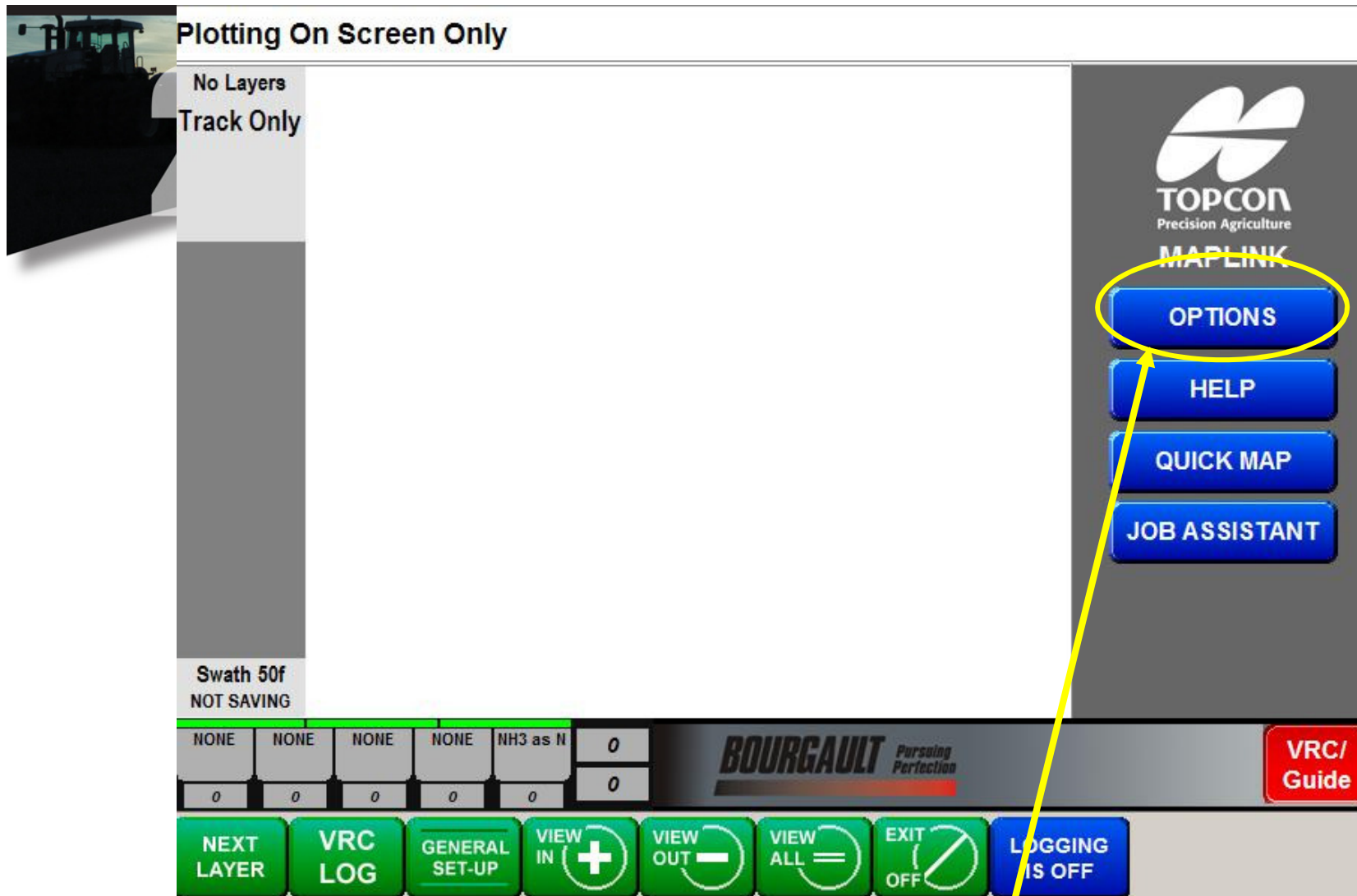

Select the Options tab in the Maplink program.

2

Plotting On Screen Only

No Layers
Track Only

General Setup Options

GPS | Config | Folder | VRC | Logging | Plotting | Units | Other

GPS Connection

COM Port	Baud rate
<input type="radio"/> Simulation	<input type="radio"/> 4800
<input type="radio"/> COM1	<input type="radio"/> 9600
<input checked="" type="radio"/> COM2	<input type="radio"/> 19200
<input type="radio"/> COM3	<input checked="" type="radio"/> 38400
<input type="radio"/> COM4	<input type="radio"/> 57600
<input type="radio"/> COM5	<input type="radio"/> 115200
<input type="radio"/> COM6	
<input type="radio"/> COM7	
<input type="radio"/> COM8	

Show GPS Info.

Swath 50f
NOT SAVING

Enable Advanced

ABOUT Help CLOSE

VRC/ Guide

NEXT LAYER VRC LOG GENERAL SET-UP VIEW IN + VIEW OUT - VIEW ALL = EXIT OFF LOGGING IS OFF

Select COM2 for
Maplink

Select 38400 for the Baud rate

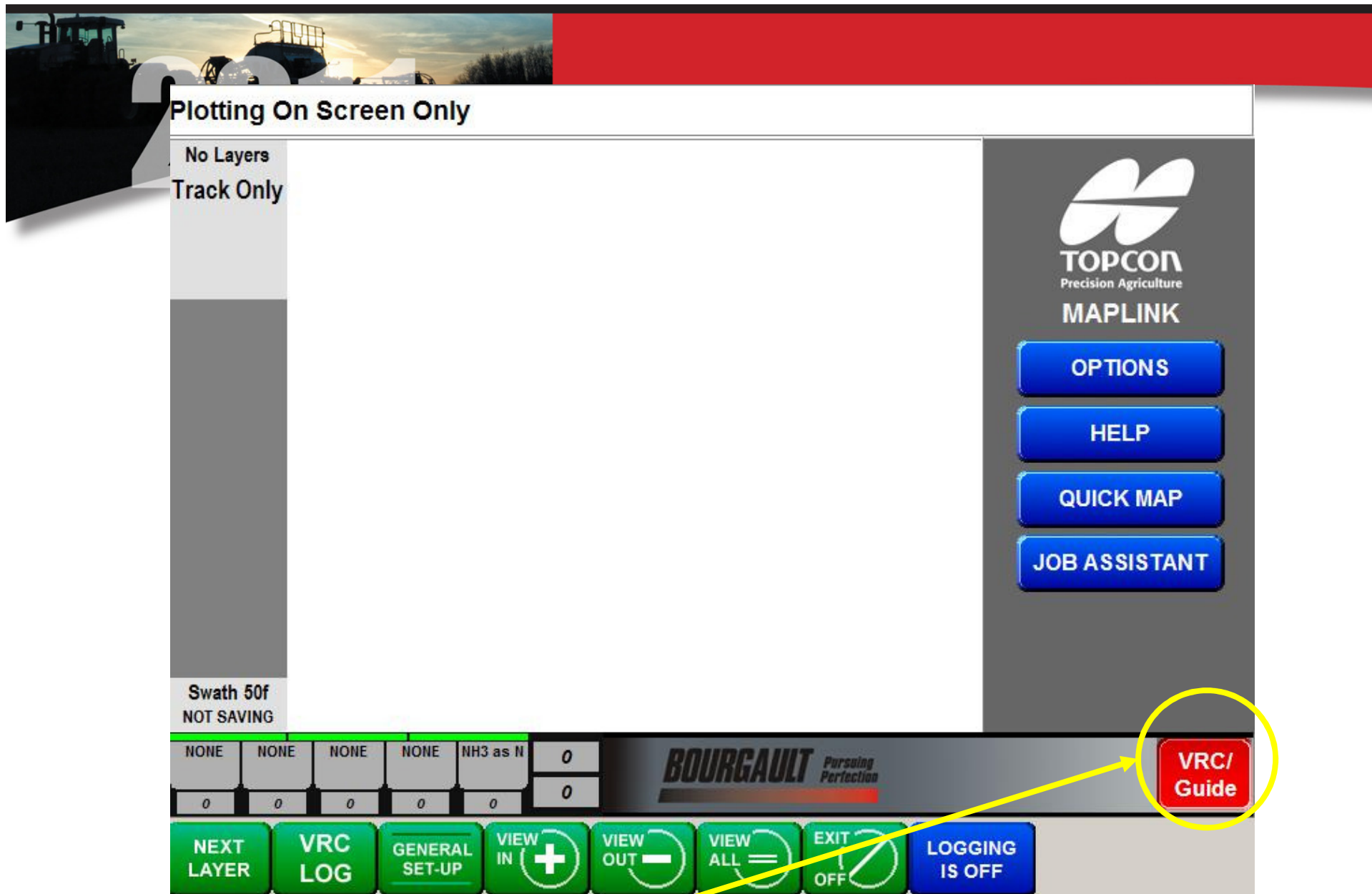

Press the **VRC/ Guide** tab top cycle to the Guidance program.

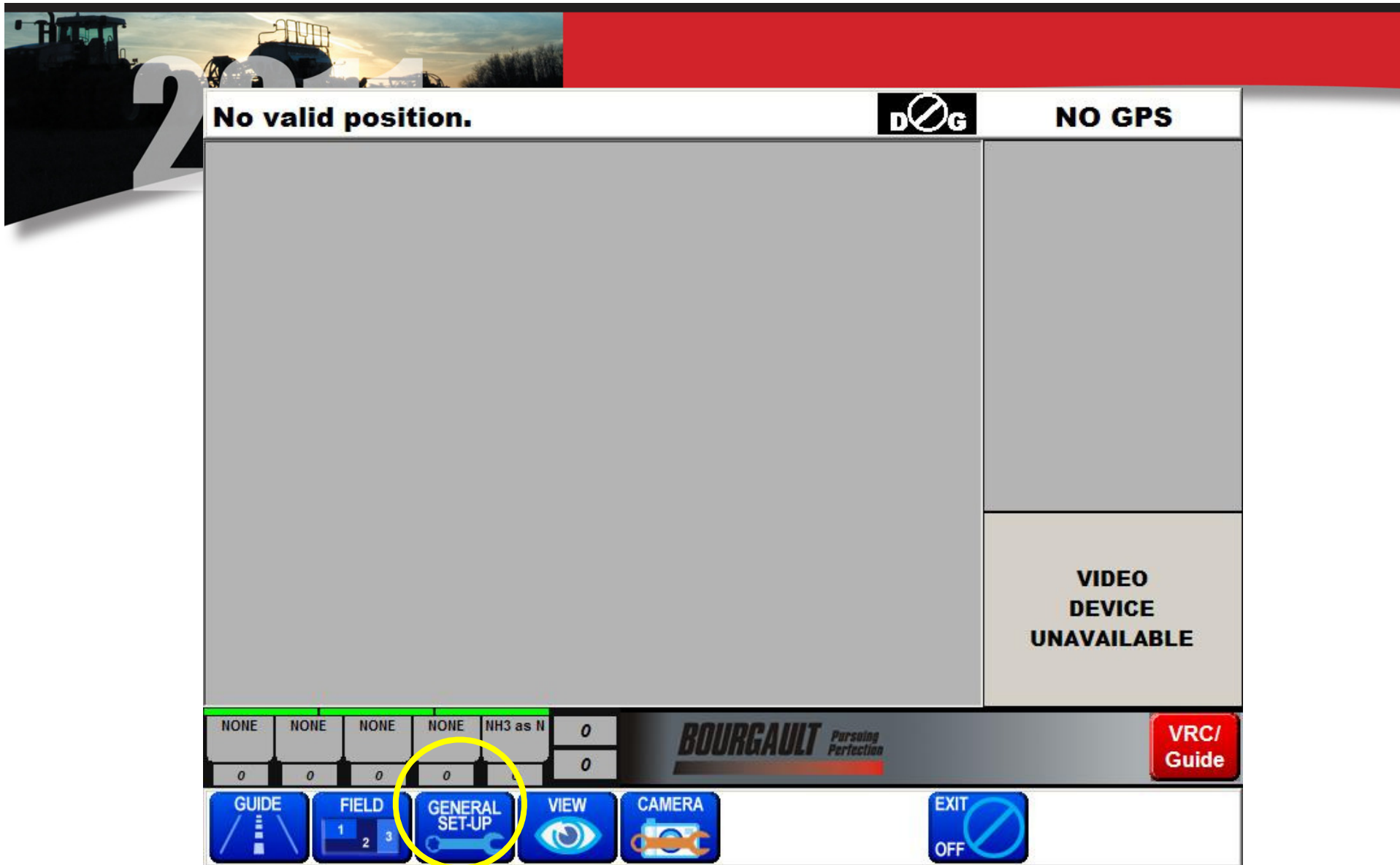

Press the **General Set-up** tab

No valid position.



NO GPS

General Setup (English Ver 4.46.04065 Sep 8 2010) -FW

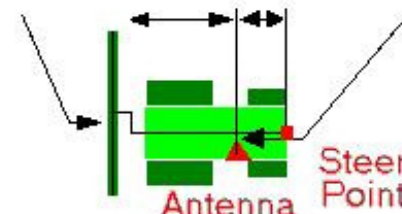
GRIDS <input type="radio"/> On Spacing: 300 ft <input checked="" type="radio"/> Off Backlight: <input type="text"/>	GUIDE >>>> Virtual Road	OFFSETS Implement: 0.00 in Flow: 0.0 in Steer: 0.0 in Antenna: 0.00 in
GUIDANCE Lock Dir.: <input type="radio"/> Left first <input checked="" type="radio"/> Right first <input type="radio"/> Left only <input type="radio"/> Right only	GPS Port/Baud: COM1: 38400 <input type="checkbox"/> Non-diff <input checked="" type="checkbox"/> 10Hz paint	
UNITS Measure: <input type="radio"/> Metric <input checked="" type="radio"/> Imperial <input type="checkbox"/> Swath in inches Position: <input checked="" type="radio"/> Lat/Long <input type="radio"/> E/N	GENERAL Use Toggle Switch <input type="checkbox"/> Vehicle nose <input checked="" type="checkbox"/> Draw tracks <input type="checkbox"/> Max. speed: 25.0 mph Simple outlines <input checked="" type="checkbox"/> Override available <input type="checkbox"/>	

Flag settings... Working path... Auto Section... Line shift... End of row... OK 

GUIDE **FIELD** **GENERAL SET-UP** **VIEW** **CAMERA** **EXIT** **OFF** **VRC/ Guide**

Select COM1 and 38400 as the Baud rate for Guidance



**Your X20 should be getting the GPS
signal at this point.**